

# Dent



# Dent

Playful and enigmatic

# Playfulness

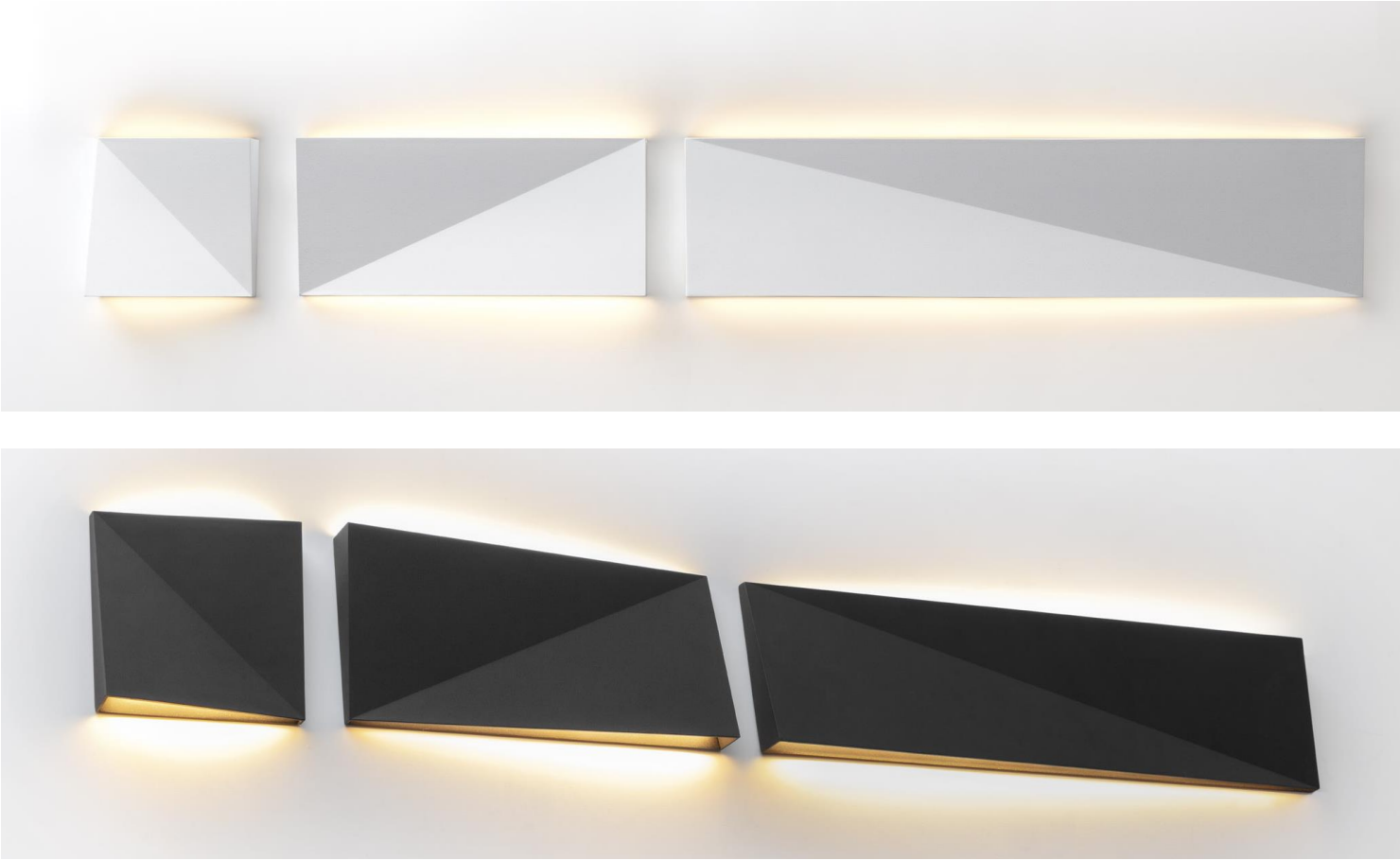

Create your own piece of art!

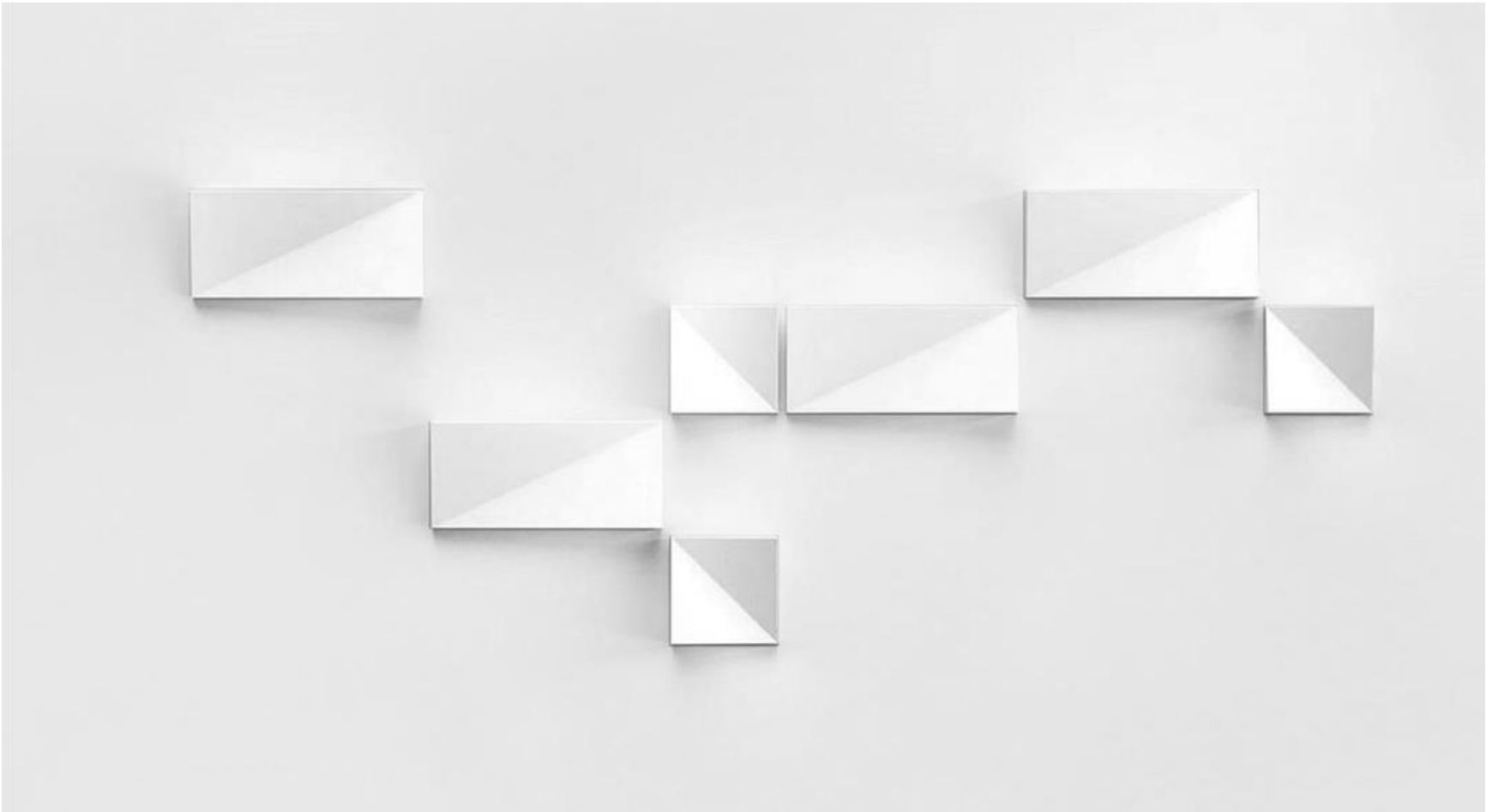

## About Dent

- Versatile wall fixture
- Minimalistic front view
- Alive and dynamic sideview

Designer: Jeffrey Huyghe





## Market segments

- High-end residential
- Hospitality

# Design

# Colours



**Black** structure



**White** structure

# Sizes



Small

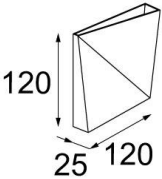

Medium

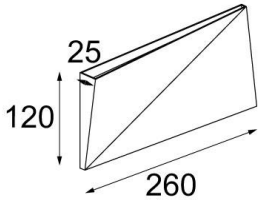

Large

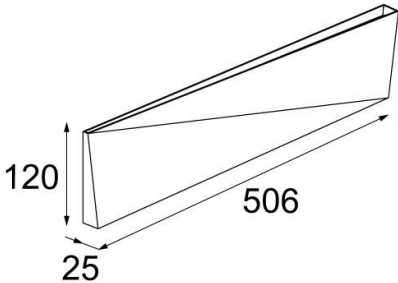

# Design features

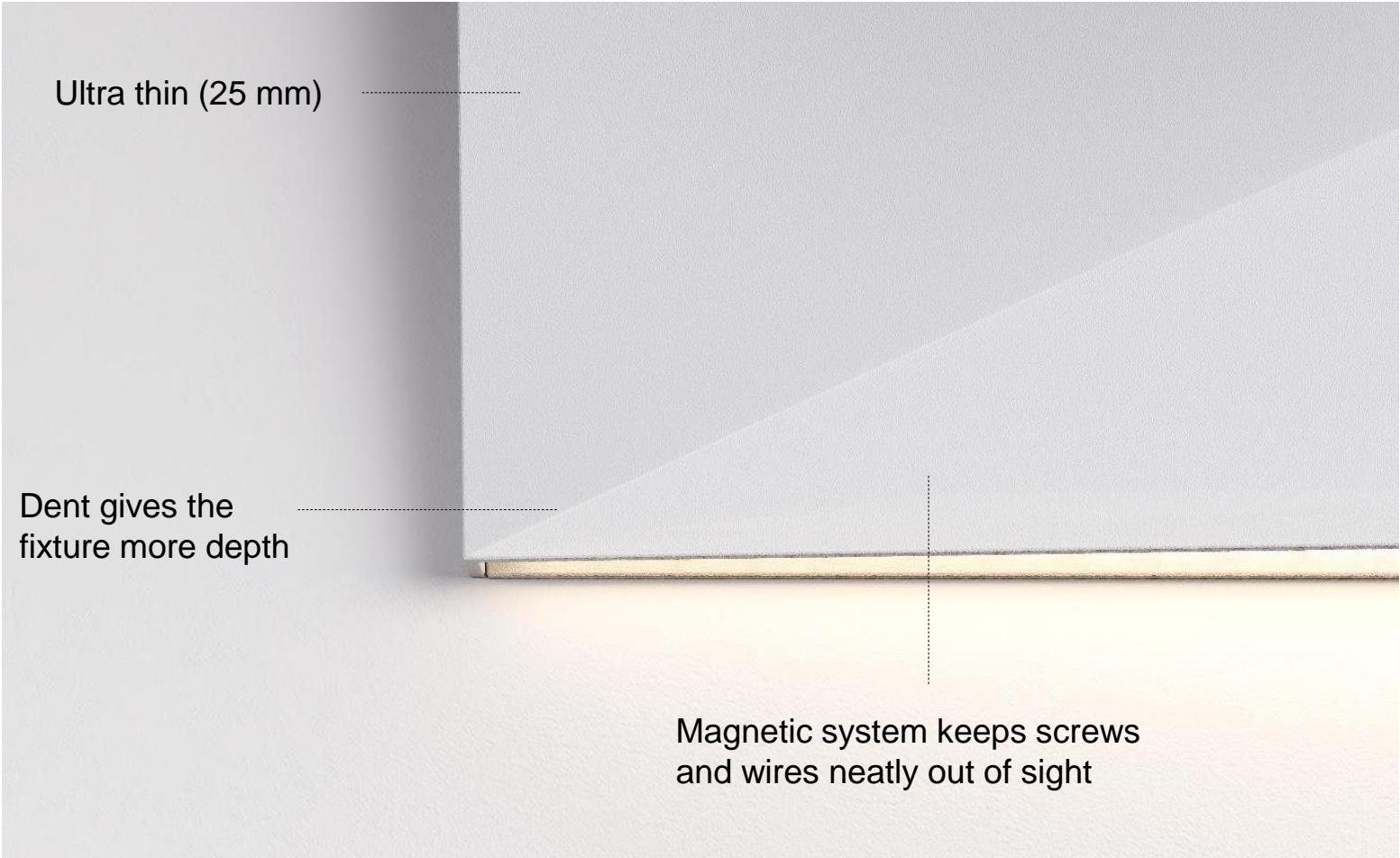

# Installation

# Step 1: Mounting of wall plate

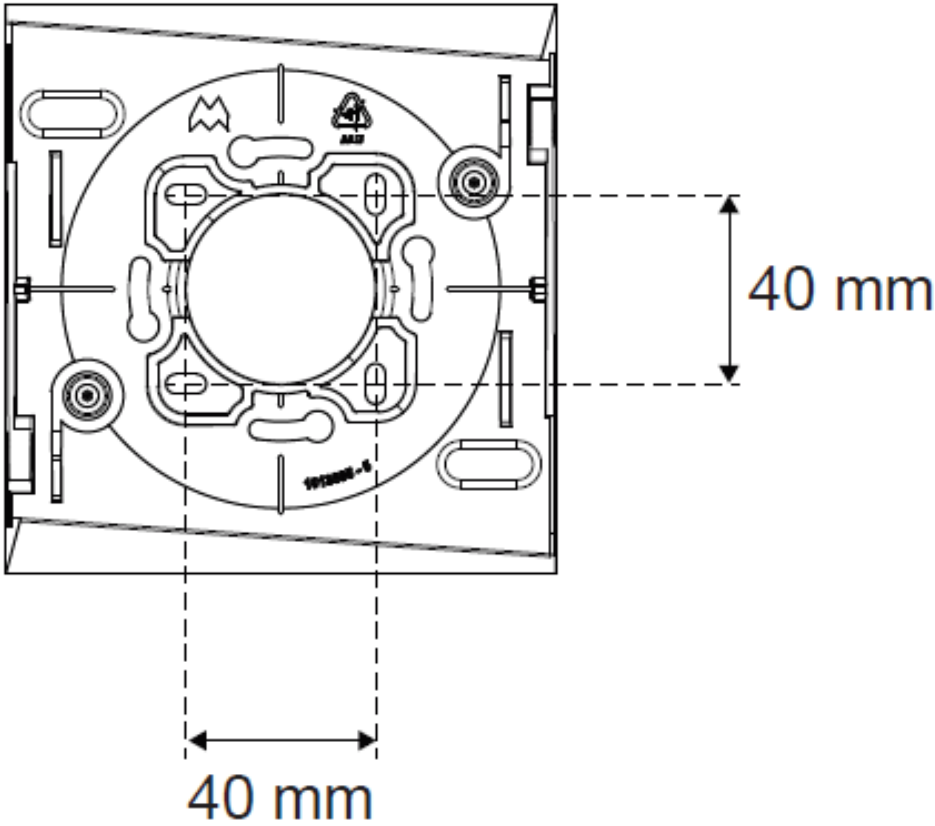

Can be used with a  
standard electrical installation box

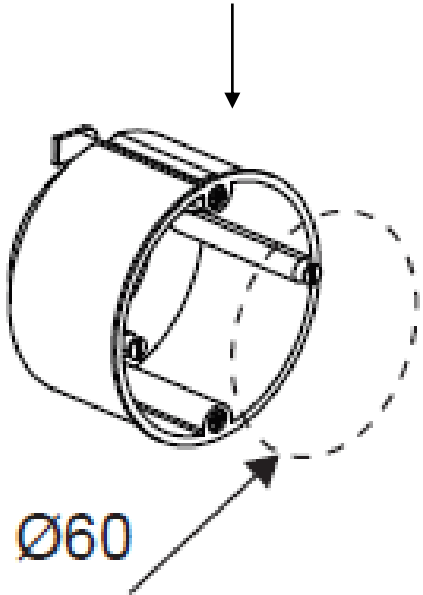

## Step 2: Make your **connection** and hide them in the wall or installation box

→ **Required space in the wall:** Ø60x50mm

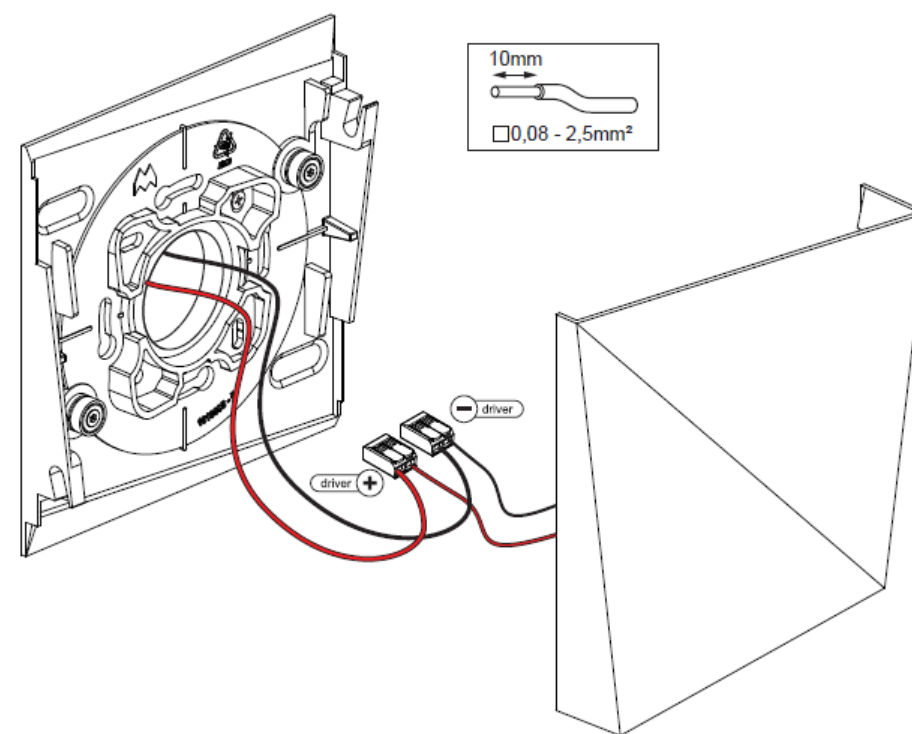

**Step 3:** Place the outer housing on the wall mounted plate  
→ **magnetic fixation!**

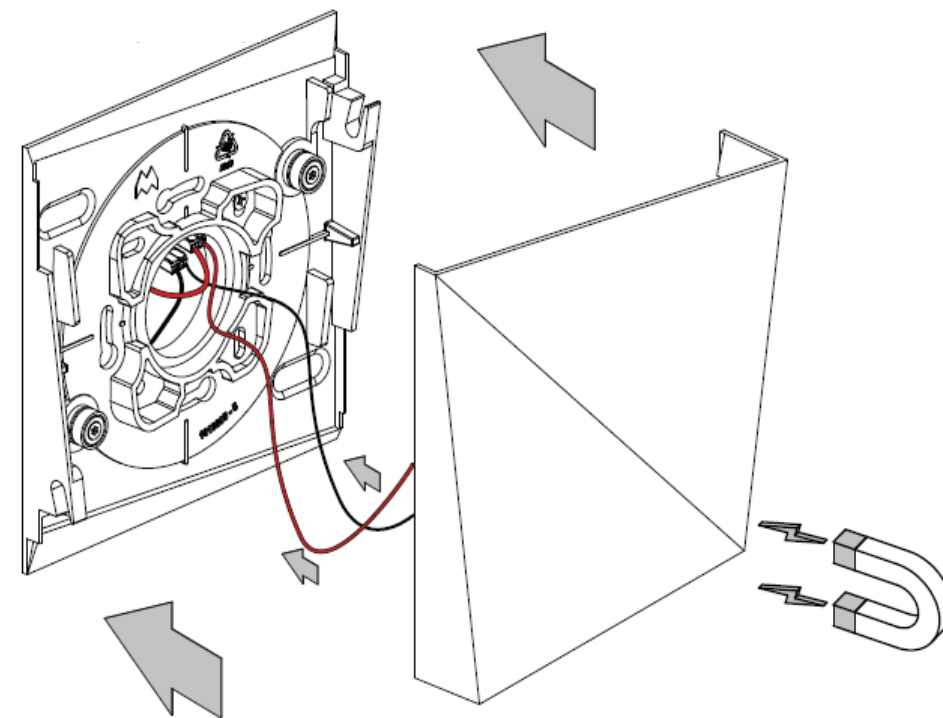

**Step 4: Anti-theft:** small hole allows the insertion of an anti-theft screw

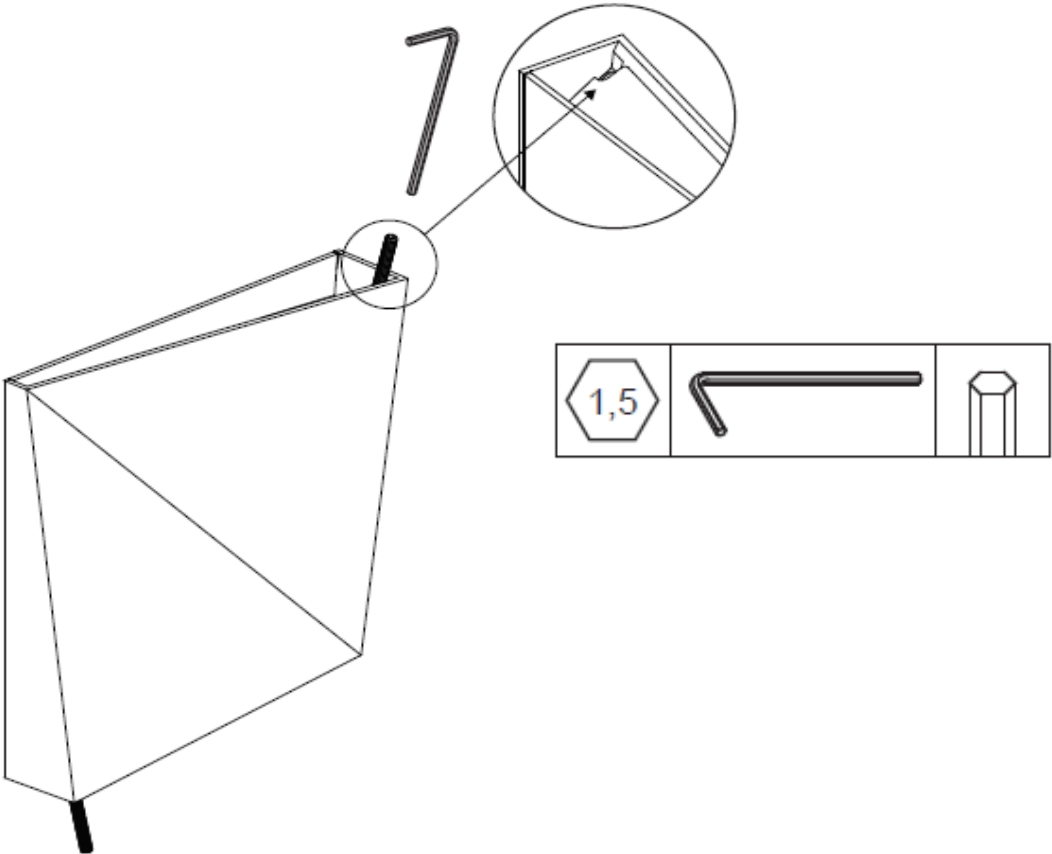

# Specifications

Dent small	Dent medium	Dent large
2700K – 3000K		
CRI90+		
IP20		
413 lm <sup>(1)</sup>	729 lm <sup>(1)</sup>	833 lm <sup>(1)</sup>
7,8 W <sup>(1)</sup>	17,6 W <sup>(1)</sup>	17,6 W <sup>(1)</sup>
53 lm/W <sup>(1)</sup>	41 lm/W <sup>(1)</sup>	47 lm/W <sup>(1)</sup>
Non-dim 1-10V Dali		

(1) 3000K, white struc, 350mA

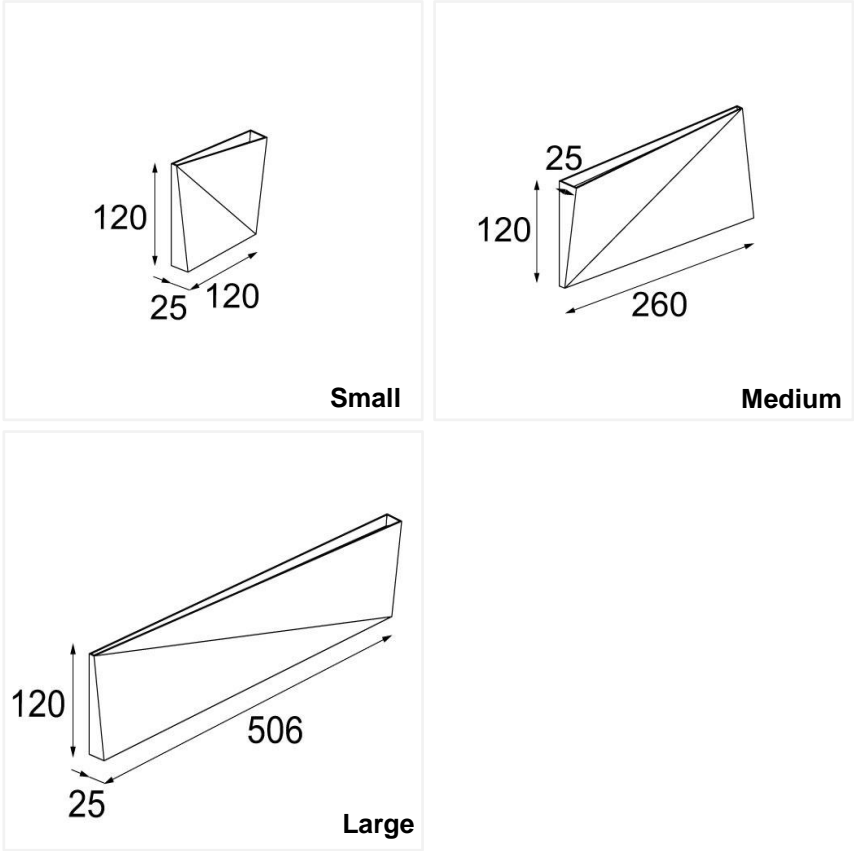

Always check our website for the most complete and up to date specifications!



## DESIGN

ULTRA THIN

NO WIRES, NO SCREWS

MINIMALISTIC BUT PLAYFULL

SIGNATURE BY DIAGONAL LINE

BLACK AND WHITE STRUCTURE  
FINISHINGS



## APPLICATION

CLEVER AND SMART  
INSTALLATION ON THE WALL

RESIDENTIAL  
HOSPITALITY

MOOD MAKER

GEAR EXCLUDED



## TECHNOLOGY

UP- AND DOWNLIGHT

EASY INSTALLATION  
MAGNETIC FIXATION  
ANTI-THEFT

ACCURATE COLOUR RENDERING

CONNECTED LIGHTING











