



Marbul



Marbul

“All-round” sophistication



HENRY VAN
DE VELDE
AWARDS 19
WINNER





About Marbul

- Direct light at different angles
- Reflectors sits perfectly within the globe's thin rim
- Soft curves



Designer: Jeffrey Huyghe



Market segments

- High-end residential
- Hospitality
- Boutiques

Mounting



Colours



White structure



Donkey grey structure



Black structure

Marbul 48V



Marbul track 48V
Black struc / white struc



Marbul track suspension 48V
Black struc / white struc



Marbul track suspension adj 48V
Black struc / white struc

Marbul 48V

Adjustability

- Contains same flexibility
 - H360°
 - V90°

Mechanical lock

- Because of weight: mechanical lock instead of magnetic fixation



Reflectors



Aluminum



Champagne



Gold

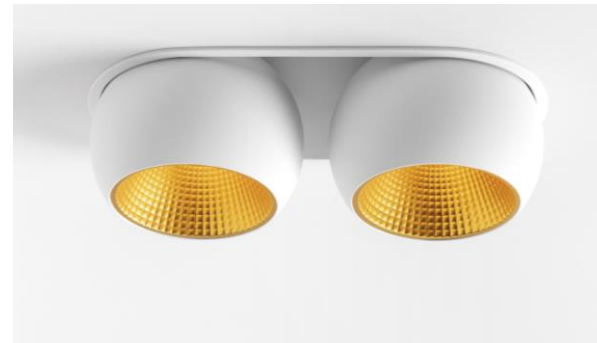
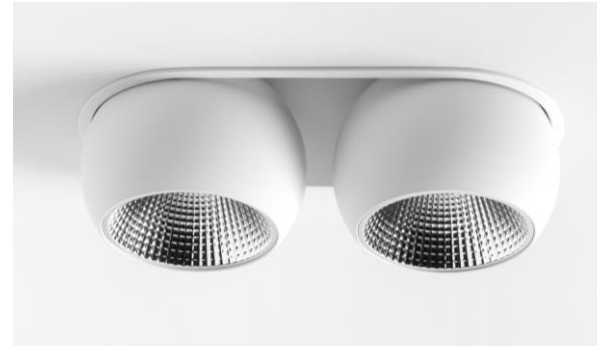

Pimp your desired light effect



Design features surface

Streamlined gearhouse for
a light and elegant look

Asymmetric globes which tilt independently

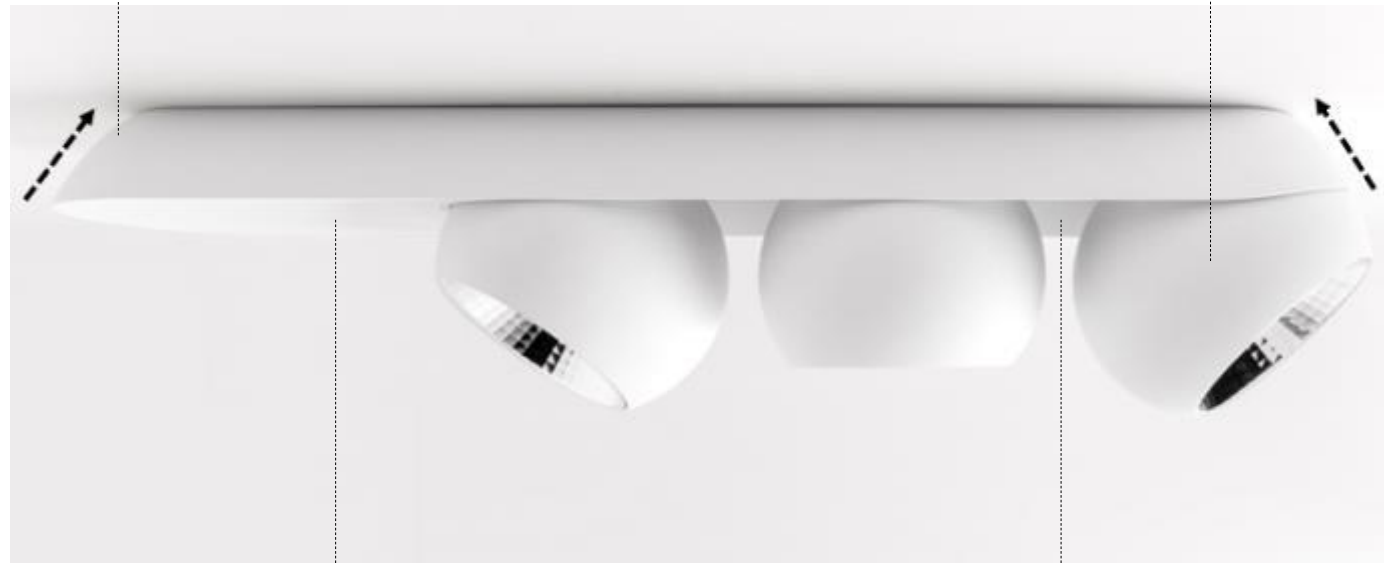

Magnetic coverplate keeps screws
and wires neatly out of sight

Shape adapted to the most
optimal adjustability

1, 2 or 3 adjustable spheres

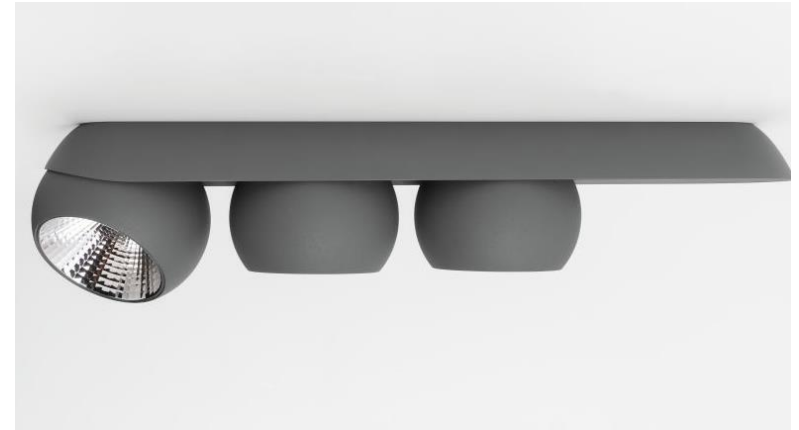

Design features recessed

Sphere embraced by recessed housing with **ultra fine border**

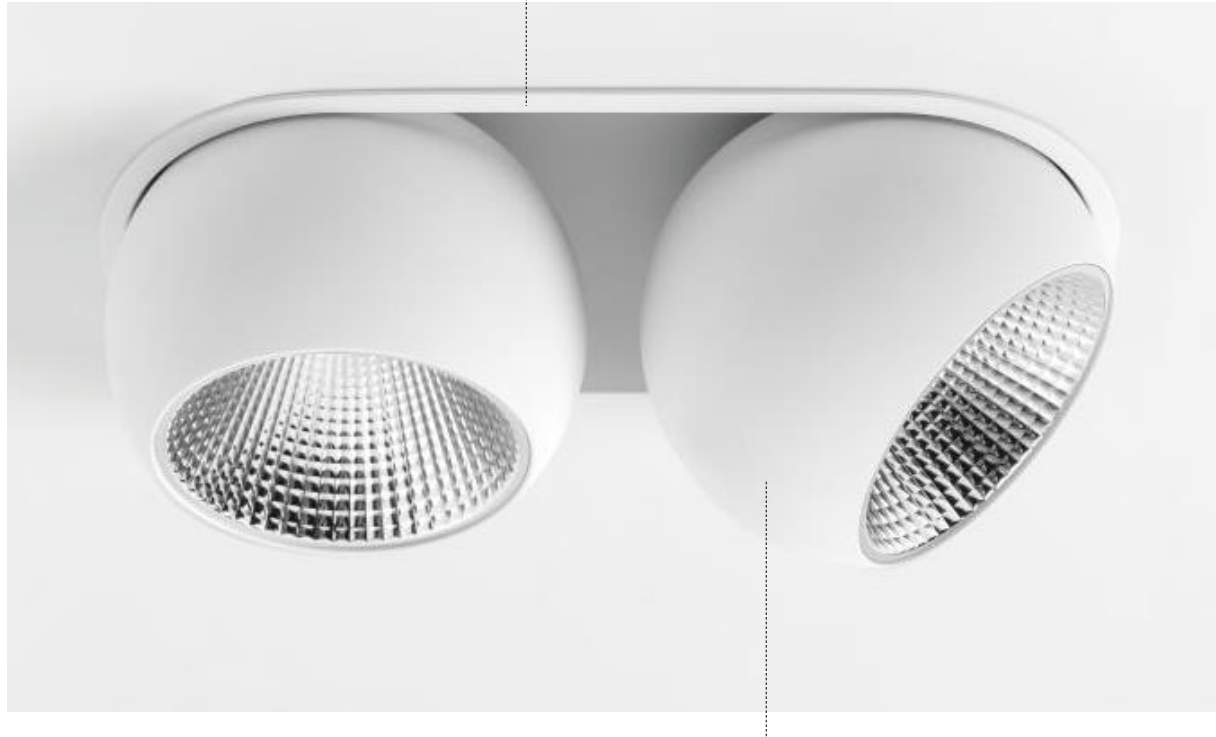

Semi-recessed, adjustable spheres

1 or 2 adjustable spheres



Design features suspension



Thin, **black cable** – 78.7 inch

With or without **rotation cap**

Playful, geometric shape

Fix or adjustable



Marbul suspension **fix**



Marbul suspension **adjustable**

Group and place at unequal heights for a playful effect



Specifications surface

Marbul 1x
2700K - 3000K - 3500K
CRI90+
10° - 25° - 40°
damp locations
748 lm ⁽¹⁾
11 W ⁽¹⁾
68 lm/W ⁽¹⁾
driver integrated 1% Tre dim/0-10V

(1) 3000K, white struc, 25°, 350mA

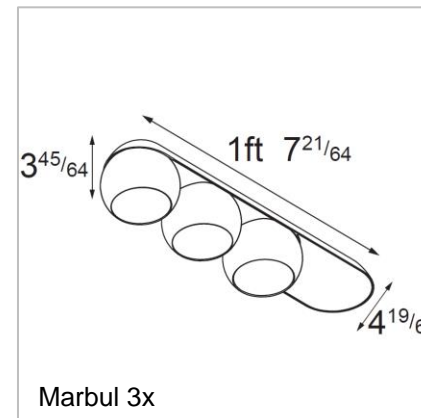
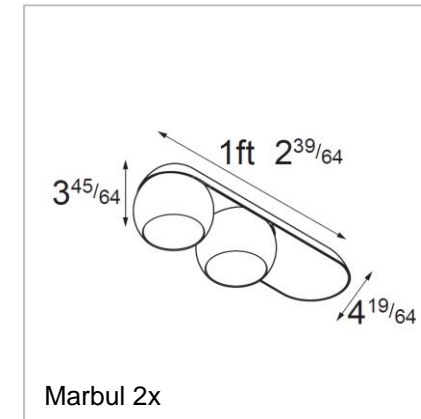
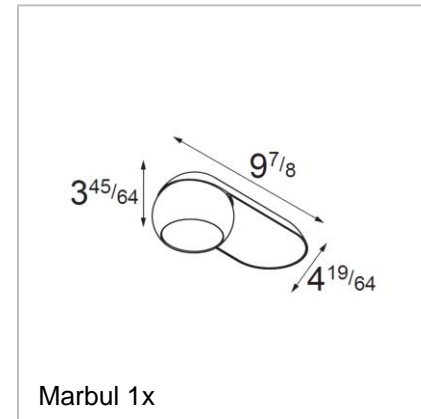

Always check our website for the most complete and up to date specifications!

Installation surface

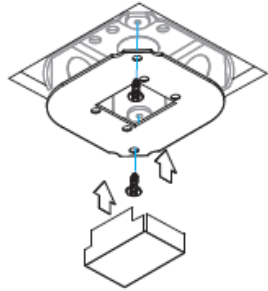

FOR OCTAGONAL BOX 4" by 4"
(POUR OCTAGONAL BOX 4" par 4")

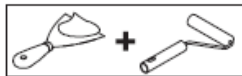
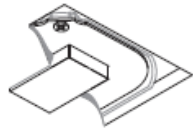

NEUTRAL (NEUTRE) = WHITE (BLANC)
GROUND (TERRE) = YELLOW/GREEN (JAUNE/VERT)
LINE (LIGNE) = BLACK (NOIR)

OPTIONAL:
0-10V + = PURPLE (VIOLET/VIOLETA)
0-10V - = GREY (GRIS/GRIS)

120-277 Vac
50/60 Hz

120 Vac
50/60 Hz

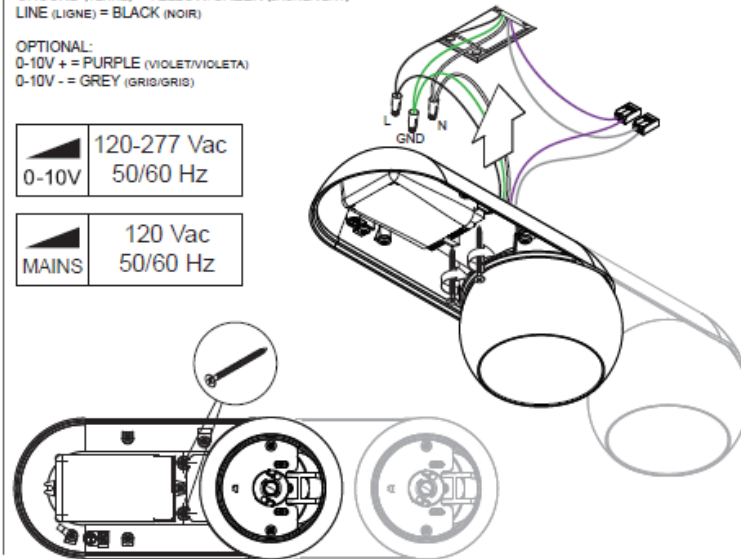

MIN 60°C (140F) SUPPLY CONDUCTORS
LES FILS D'ALIMENTATION 60°C (140F) MIN
CONDUCTORES DE ALIMENTACIÓN 60°C (140F) Min

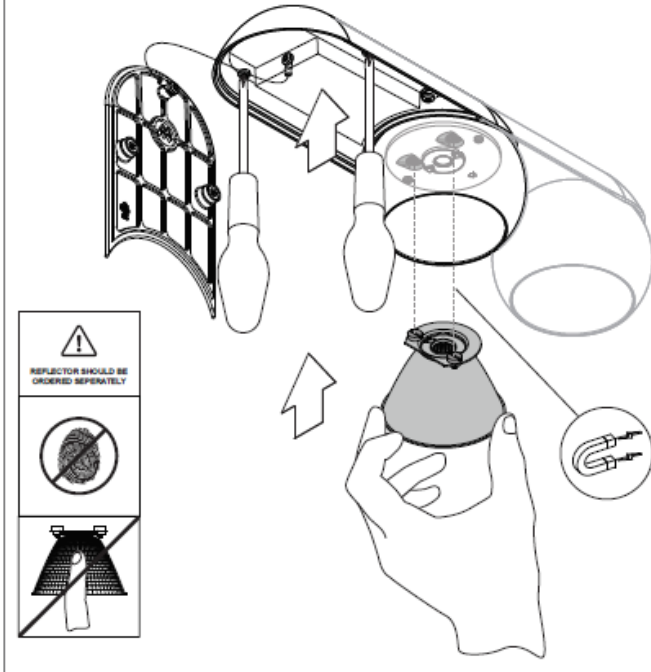

Specifications recessed

Marbul 1x	
2700K - 3000K - 3500K	
CRI90+	
10° - 25° - 40°	
damp locations	
748 lm ⁽¹⁾	1026 lm ⁽²⁾
9 W ⁽¹⁾	14 W ⁽²⁾
80 lm/W ⁽¹⁾	74 lm/W ⁽²⁾
driver excluded dimmable	

(1) 3000K, white struc, 25°, 350mA

(2) 3000K, white struc, 25°, 500mA

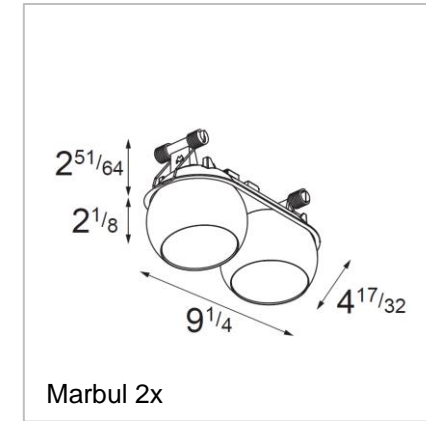
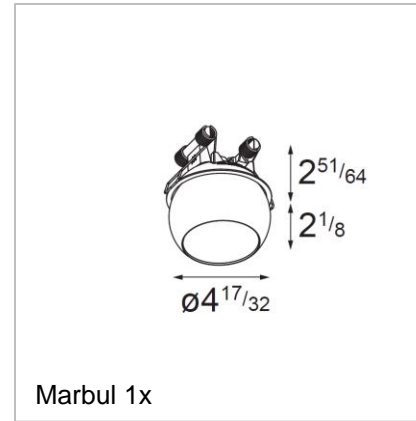

Always check our website for the most complete and up to date specifications!

Installation recessed

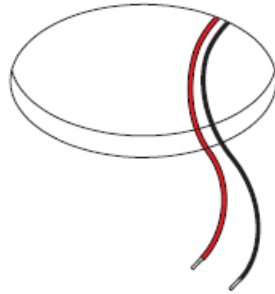

Drive Current (mA)	Forward Voltage		Power (W)
	min (Vf)	max (Vf)	
350	15,3	19,3	6,0
500	15,8	19,8	8,9

SECONDARY CONSTANT CURRENT

LED + = RED(ROUGE/ROJO)

LED - = BLACK(NOIR/NEGRO)

MAKE SURE POWER IS OFF!

(ASSUREZ-VOUS QUE L'ALIMENTATION EST COUPÉE!)

(ASEGÚRESE DE QUE ESTÁ APAGADO!)

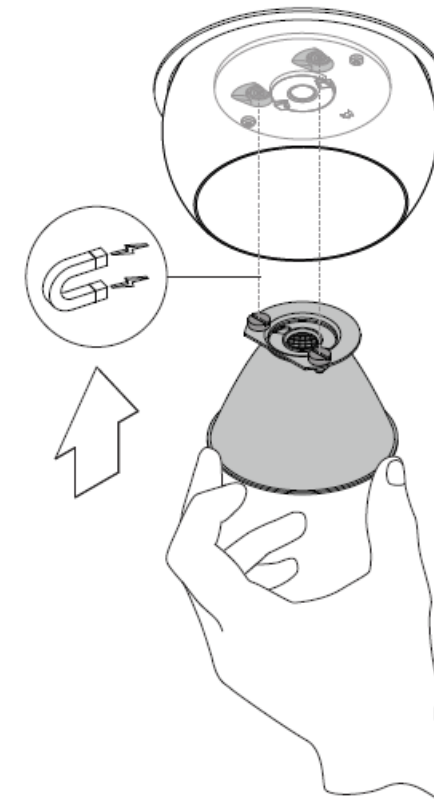
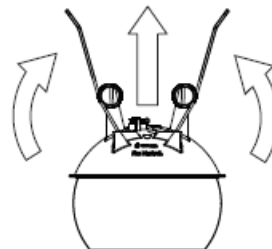
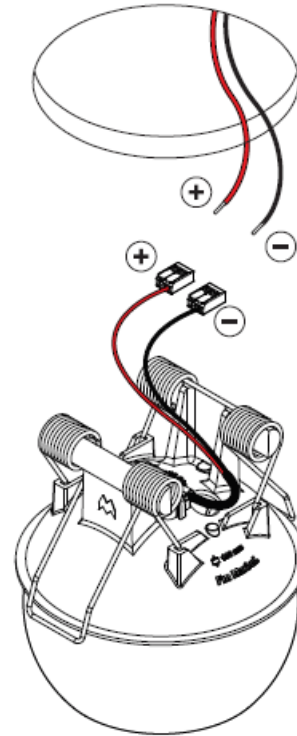

REFLECTOR SHOULD BE ORDERED SEPARATELY
LE RÉFLECTEUR DOIT ÊTRE COMMANDÉ SÉPARÉMENT
REFLECTOR SE DEBE PEDIR POR SEPARADO



Specifications suspension

Marbul - DI
2700K - 3000K - 3500K
CRI90+
10° - 25° - 40°
damp locations
748 lm ⁽¹⁾
9 W ⁽¹⁾
80 lm/W ⁽¹⁾
driver integrated 1% Tre dim/0-10V

(1) 3000K, white struc, 25°, 350mA

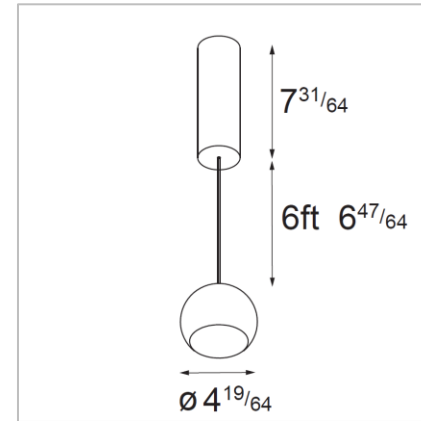

Marbul DI

Always check our website for the most complete and up to date specifications!

Installation suspension

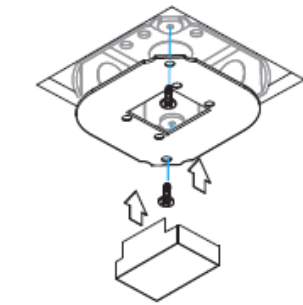

FOR OCTAGONAL BOX 4" by 4"
(POUR OCTAGONAL BOX 4 "par 4")

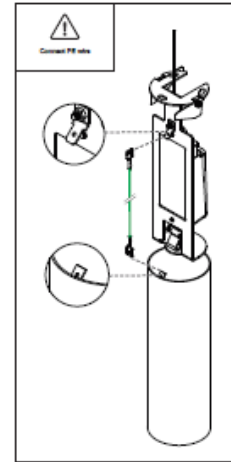
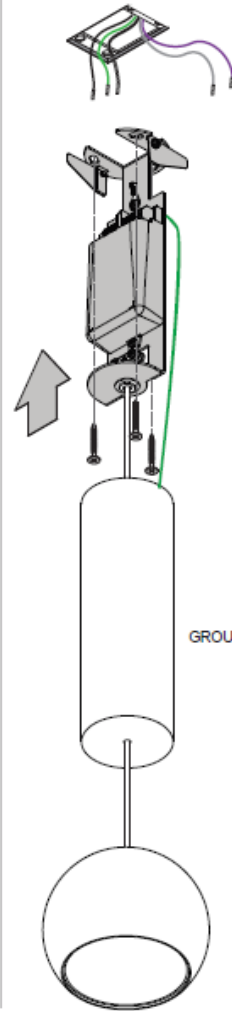
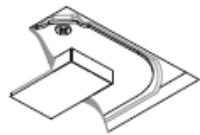

120-277 Vac
0-10V 50/60 Hz

120 Vac
MAINS 50/60 Hz

NEUTRAL (NEUTRE) = WHITE (BLANC)
GROUND (TERRE) = YELLOW/GREEN (JAUNE/VERT)
LINE (LIGNE) = BLACK (NOIR)

OPTIONAL:
0-10V + = PURPLE (VIOLET/VIOLETA)
0-10V - = GREY (GRIS/GRIS)

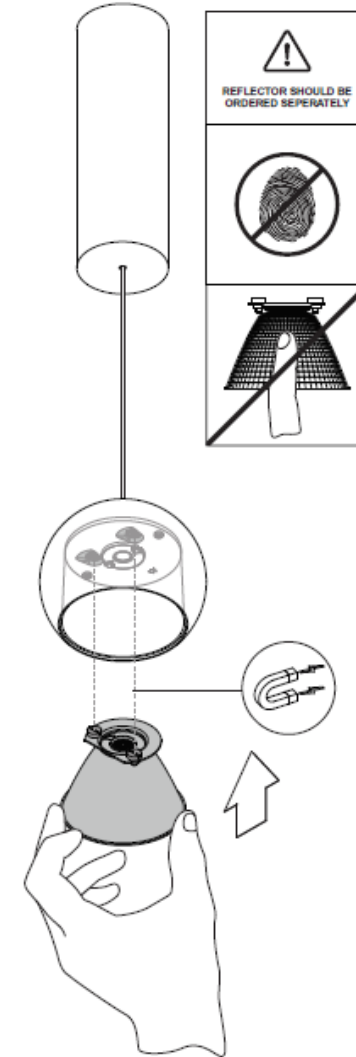
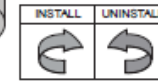
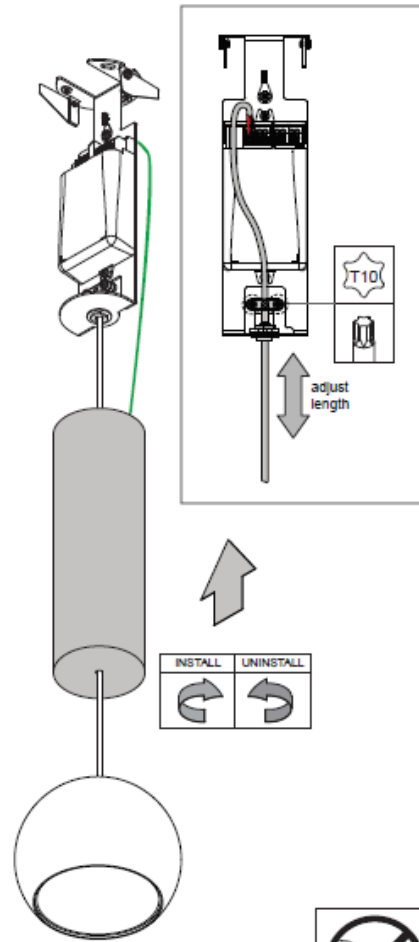

Specifications

Marbul (suspension)	
2700K – 3000K – 3500K	1800K – 3000K
CRI90+	
10° - 25° - 40°	25° - 40°
h360° v45°	
718 lm ⁽¹⁾	955 lm ⁽¹⁾
8,5 W ⁽¹⁾	15 W ⁽¹⁾
84 lm/W ⁽¹⁾	65 lm/W ⁽¹⁾
0-10V Dali	

(1) 3000K, white struc, medium

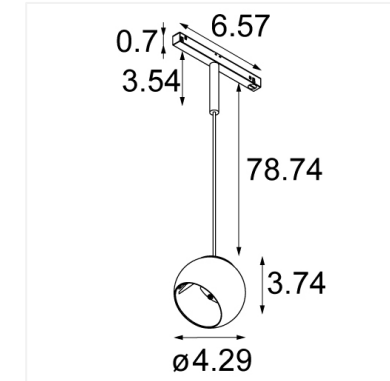
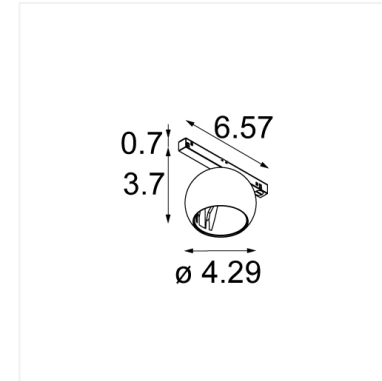

Always check our website for the most complete and up to date specifications!

INSTALLATION

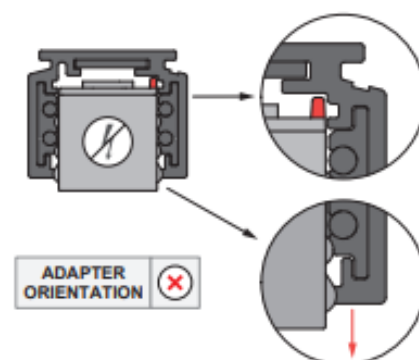
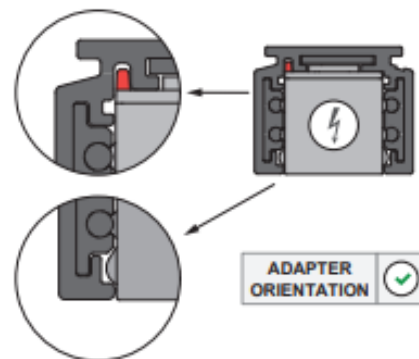
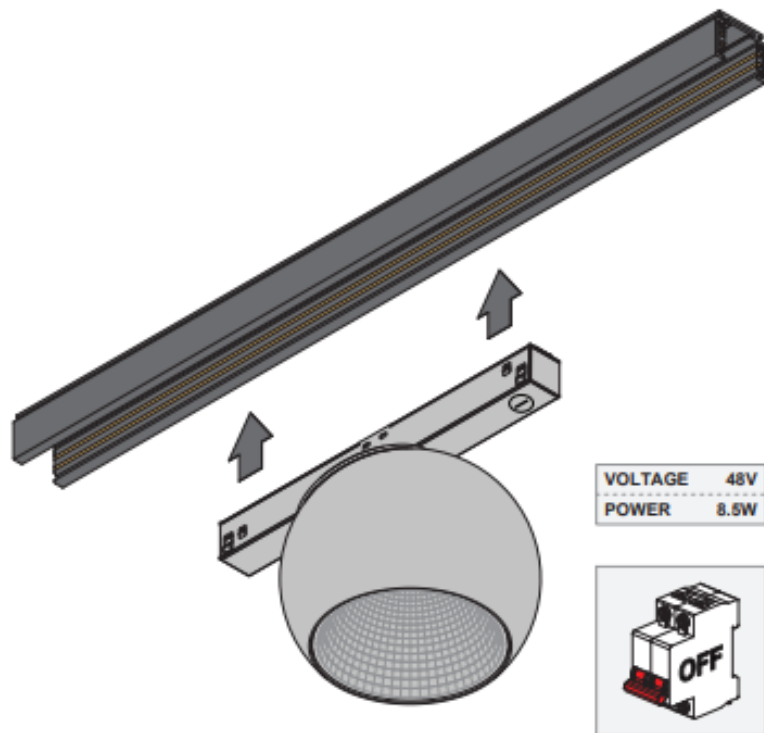

ROTATE BALL TO ADJUST

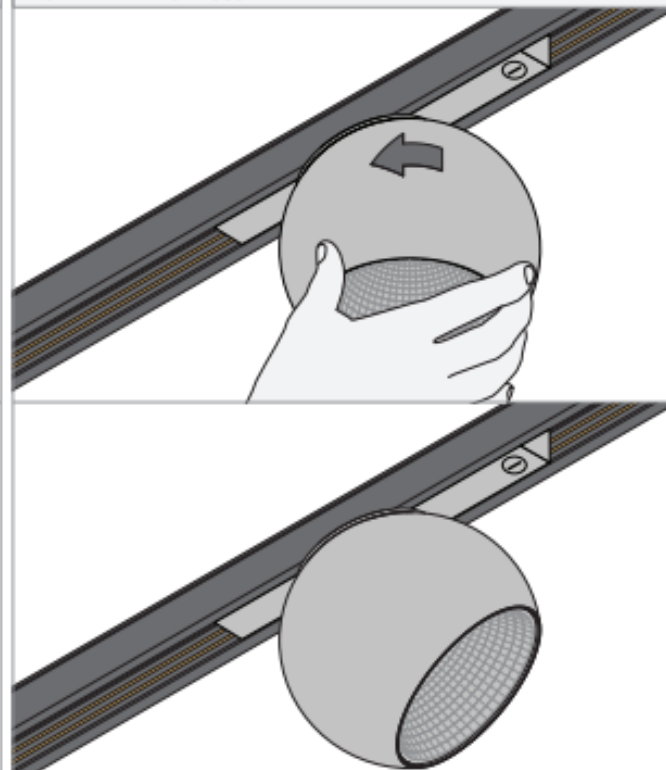

REMOVAL

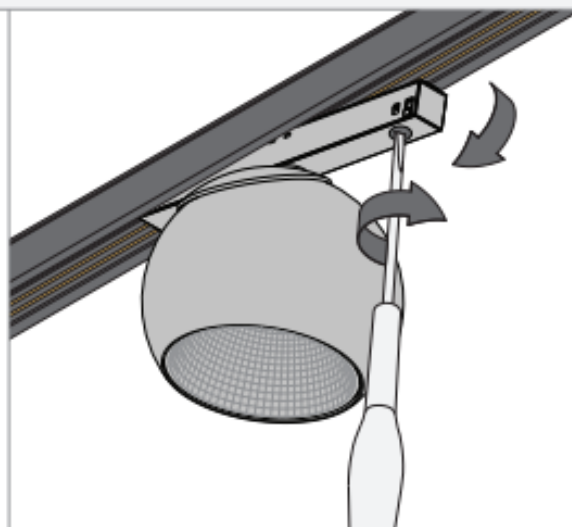
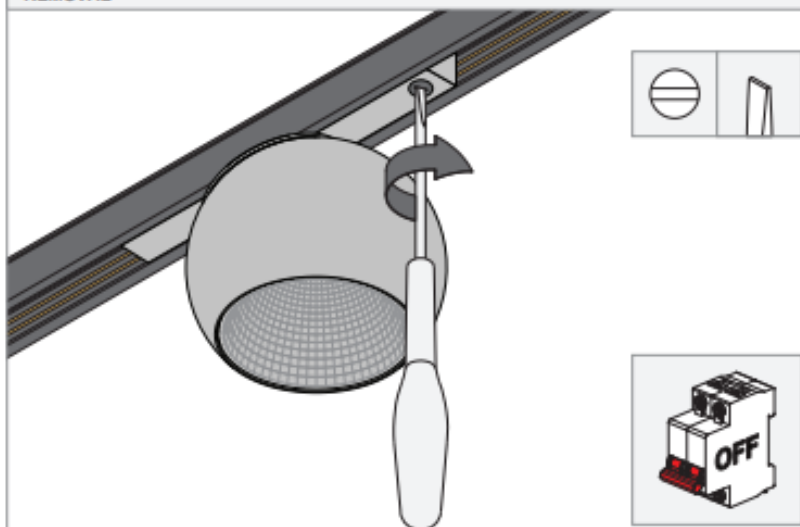

INSTALLATION INSTRUCTION

- Read all instructions before installing the luminaire.
- Save these instructions and refer to them when additions or changes in the track configuration are made.

DRY LOCATIONS ONLY

Do not install this track luminaire in damp or wet locations.

IMPORTANT SAFETY INSTRUCTIONS

- Do not install any part of a track system less than 5 feet above the floor.
- Do not install any luminaire closer than 6 inches from any curtain, or similar combustible material.
- Disconnect electrical power before adding to or changing the configuration of the track.
- Do not attempt to energize anything other than lighting track luminaires on the track. To reduce the risk of fire and electric shock, do not attempt to connect power tools, extension cords, appliances, and the like to the track.
- Do not connect a track to more than one branch circuit unless the track is constructed so that it can be used with more than one branch circuit. Check with a qualified electrician. Although the track lighting system may seem to operate acceptably, a dangerous overload of the neutral may occur and result in a risk of fire.

MUST BE COMBINED WITH

(NOT INCLUDED)

- Magnetic reflector Ø3.2 LED (1x)

FOR USE ONLY WITH TRACK SYSTEM MODEL

Series 9500, manufactured by AAG Stucchi SRL (Modular Lighting Instruments 'Pista').

TRACK SYSTEM & ACCESSORIES

For latest version of track system components and available accessories check www.supermodular.us or connect with your sales contact.

INSTALLATION

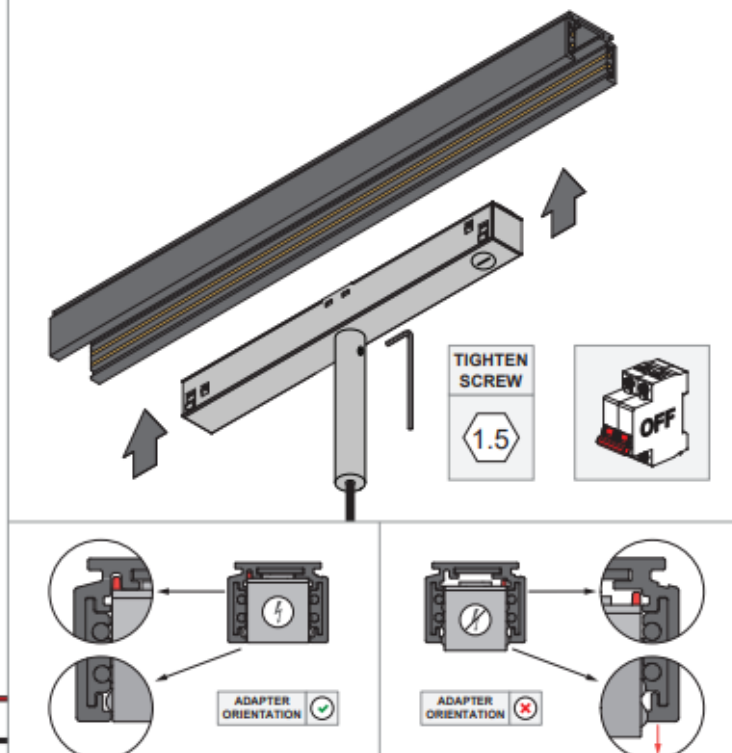
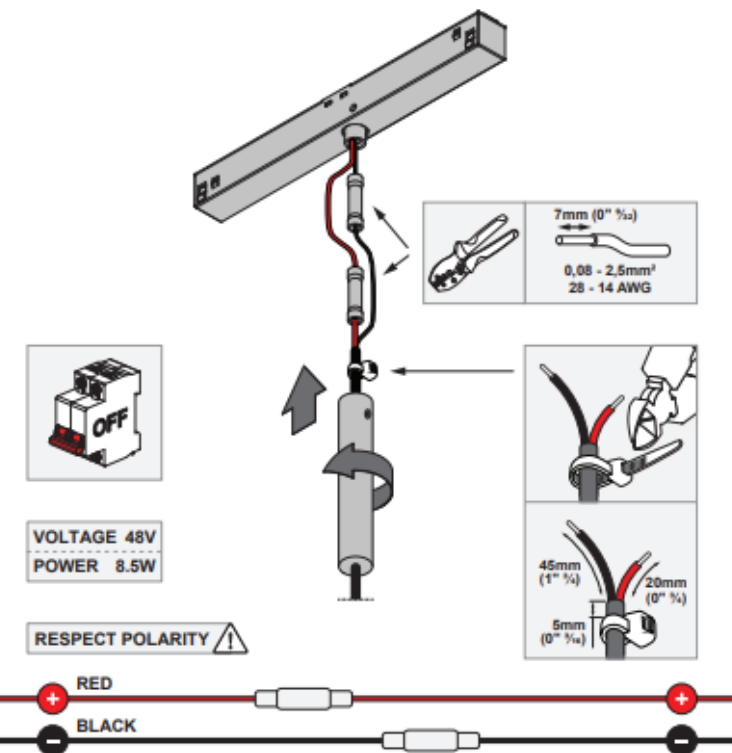

ROTATE BALL TO ADJUST

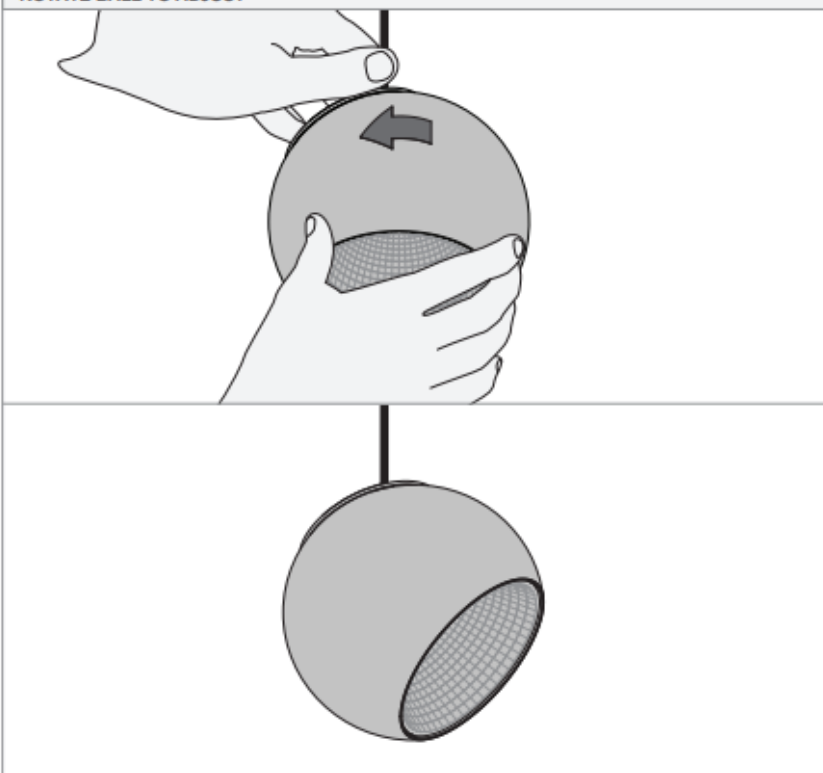

REMOVAL

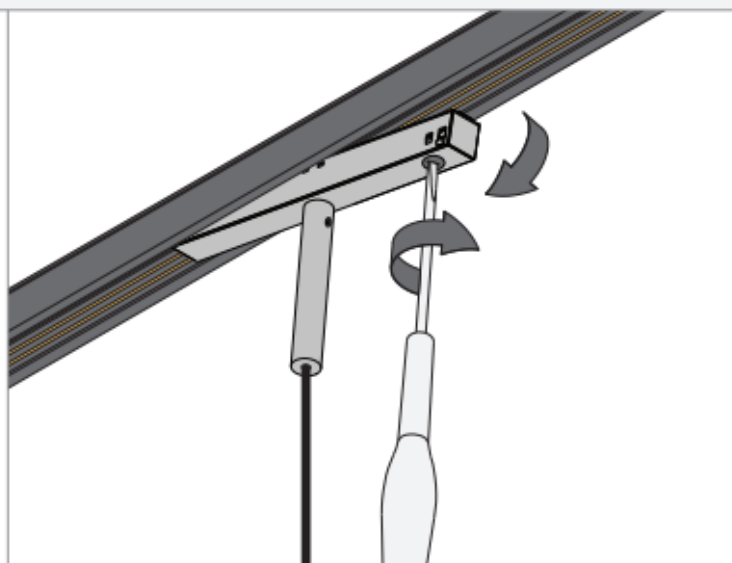
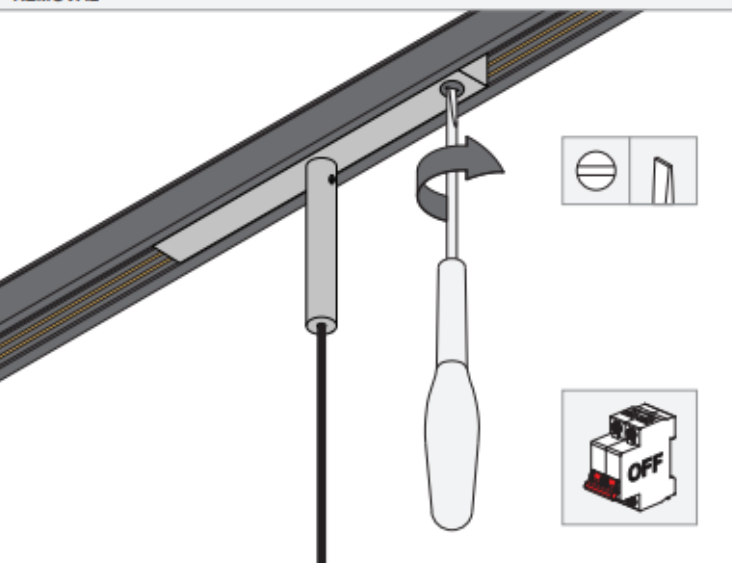

INSTALLATION INSTRUCTION

- Read all instructions before installing the luminaire.
- Save these instructions and refer to them when additions or changes in the track configuration are made.

DRY LOCATIONS ONLY

Do not install this track luminaire in damp or wet locations.

IMPORTANT SAFETY INSTRUCTIONS

- Do not install any part of a track system less than 5 feet above the floor.
- Do not install any luminaire closer than 6 inches from any curtain, or similar combustible material.
- Disconnect electrical power before adding to or changing the configuration of the track.
- Do not attempt to energize anything other than lighting track luminaires on the track. To reduce the risk of fire and electric shock, do not attempt to connect power tools, extension cords, appliances, and the like to the track.
- Do not connect a track to more than one branch circuit unless the track is constructed so that it can be used with more than one branch circuit. Check with a qualified electrician. Although the track lighting system may seem to operate acceptably, a dangerous overload of the neutral may occur and result in a risk of fire.

MUST BE COMBINED WITH

(NOT INCLUDED)

- Magnetic reflector Ø3.2 LED (1x)

FOR USE ONLY WITH TRACK SYSTEM MODEL

Series 9500, manufactured by AAG Stucchi SRL (Modular Lighting Instruments 'Pista').

TRACK SYSTEM & ACCESSORIES

For latest version of track system components and available accessories check www.supermodular.us or connect with your sales contact.



DESIGN

ORGANIC FLOWING FORMS

ULTRA THIN REFLECTOR TRIM

NO WIRES, NO SCREWS

WHITE, BLACK & DONKEY GREY
FINISHINGS



APPLICATION

ACCENT LIGHTING

HIGH-END RESIDENTIAL
HOSPITALITY

CEILING & WALL MOUNTING

SURFACE-MOUNTED, RECESSED
AND SUSPENDED



TECHNOLOGY

360° ROTATION, 45° INCLINATION

POWERFUL LUMEN PACKAGE

ACCURATE COLOR RENDERING

WARM DIM TECHNOLOGY

FROM SUPER SPOT TO FLOOD















