

Market introduction

SEPTEMBER 19, 2023

Thimble

Thimble

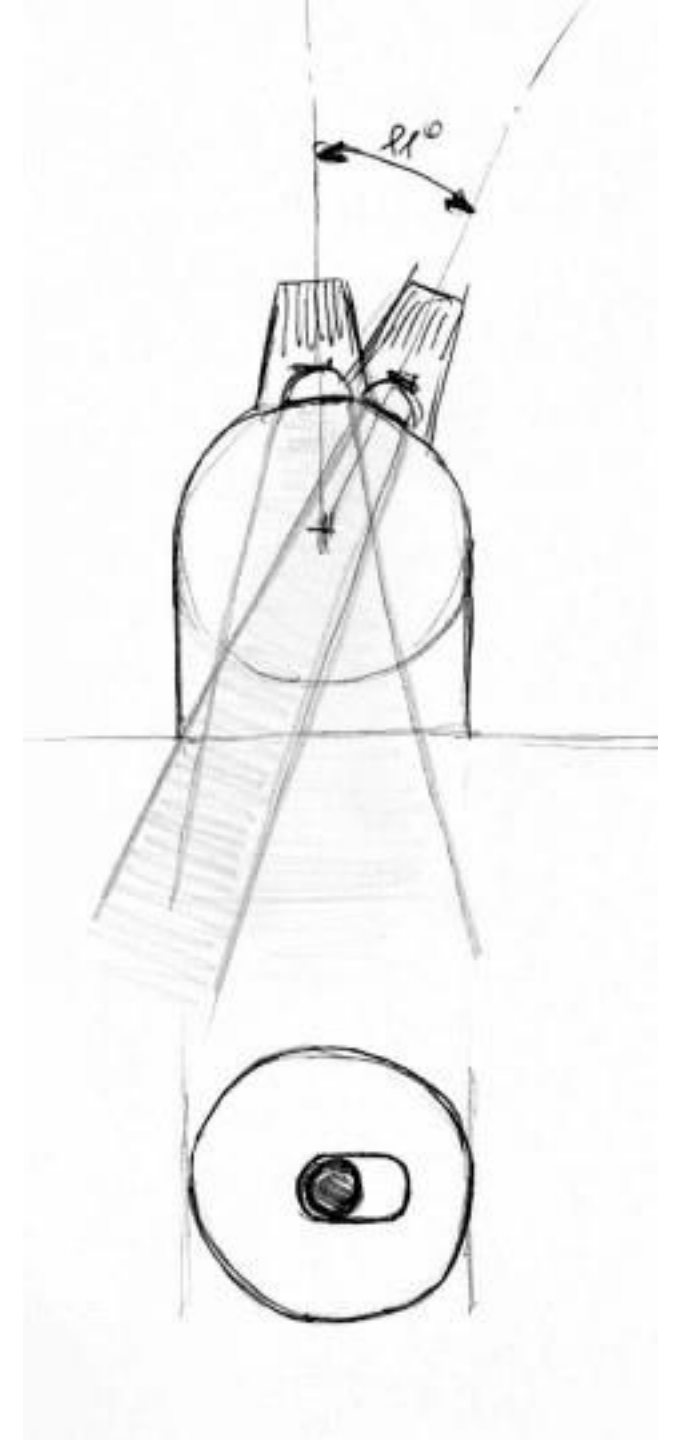

Thimble | spot

- New spot beam angle: **16°**
 - Glass aspherical lens
- Offered in **all Thimble versions**

NEW

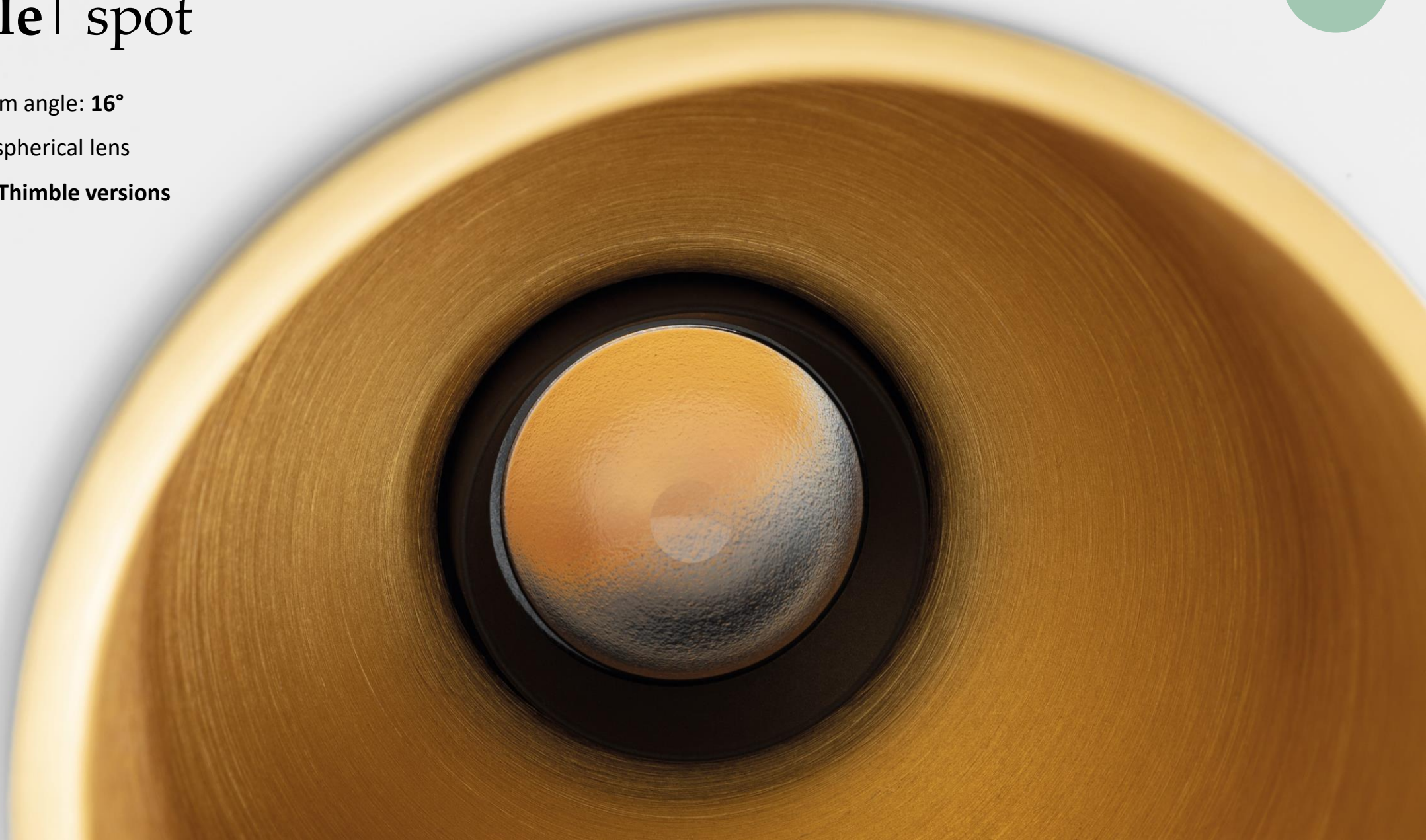





ASPHERICAL LENS 16°
LED 704lm
789 lux in the center at 2m

ASPHERICAL LENS 30.4°
LED 984lm
622 lux in the center at 2m



REFLECTOR 25°
Smart



TIR LENS 25°
Tetrix



ASPHERICAL LENS 30°
Thimble

Thimble spot | specifications

Thimble spot	Thimble medium
2700K 3000K	
CRI90+	
286lm	608 lm
6.1 W – 500mA	8.5 W – 500mA
47 lm/W	72 lm/W
DE	

Thimble, 3000K, white structure



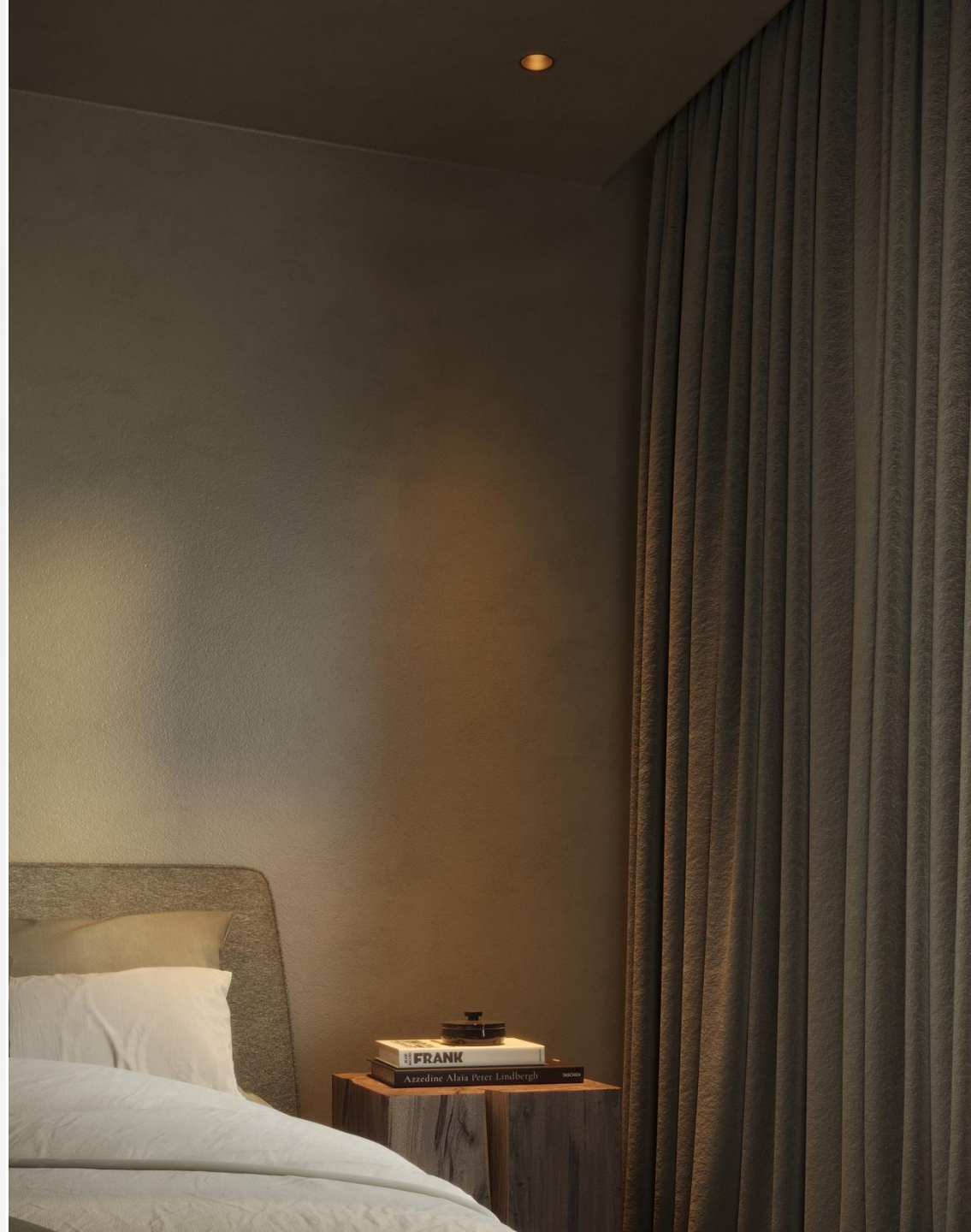

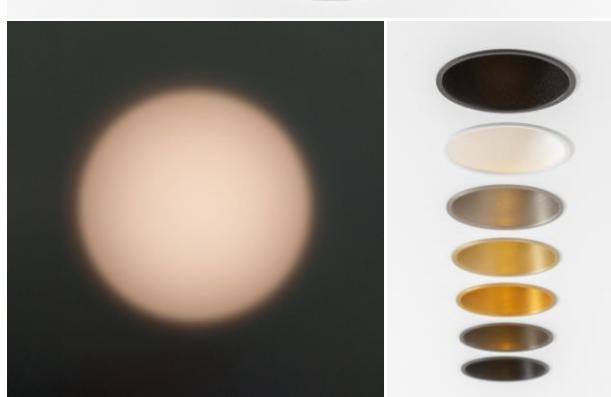
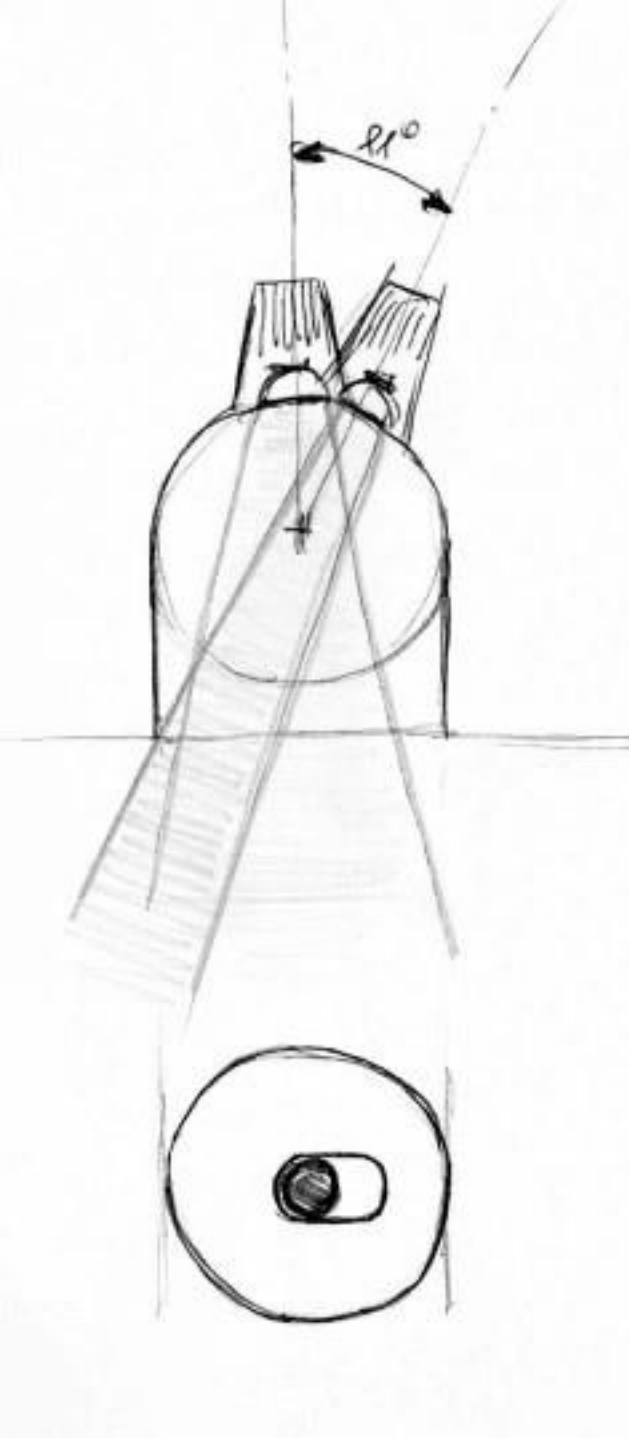

Thimble

What's in a name

- Thimble refers to a metal cap with a closed end, worn to protect the finger and push the needle in sewing

Key features

- Curved, minimalistic shape made of deep drawn aluminum sheet
- Ultra thin trim of 3.5mm or trimless
- Adjustable: form defined by function. LED module follows the curve of the body. Reducing internal reflection and guiding the light out in an efficient way.
- Deep recessed light source: visual comfort
- Custom-made aspherical, textured lens → concentrated light beam with soft fade out adding drama and contrast in a room
- Glass lens → infinite optical performance
- Lens surrounded by thin black collar making it easily adjustable
- Slot hole is covered by black cover preventing peeping into the ceiling
- Asymmetric heatsink ensures adjustment within cut-out hole
- Rich and luxurious look and feel thanks to the brushed anodized sophisticated finishes
- Structured powder coated or brushed anodized sophisticated finishes
- No installation restrictions: extensive range of installation accessories

Designed by Jeffrey Huyghe

Modupoint

Modupoint | 1984

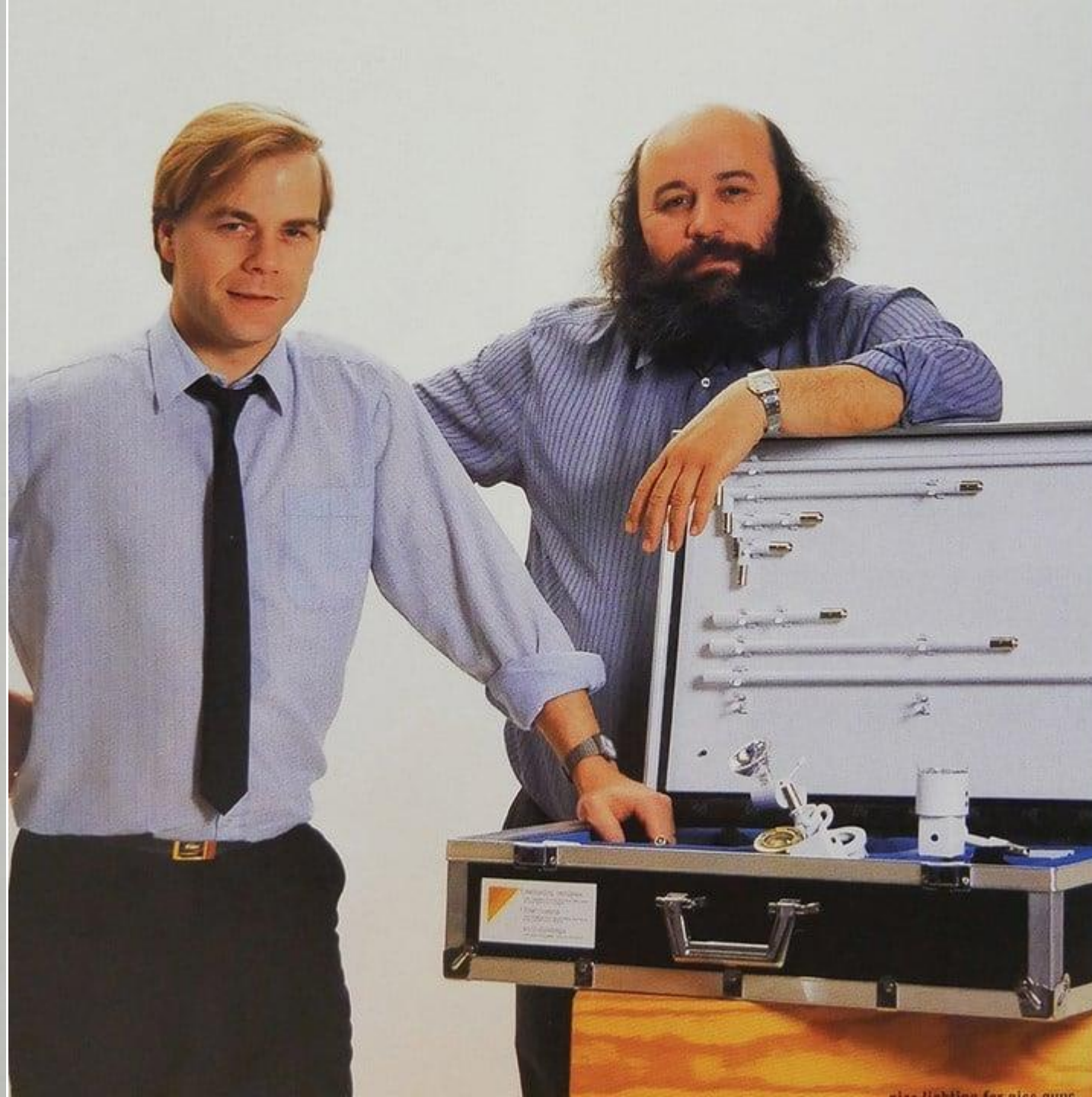

Modupoint | 39 years later...

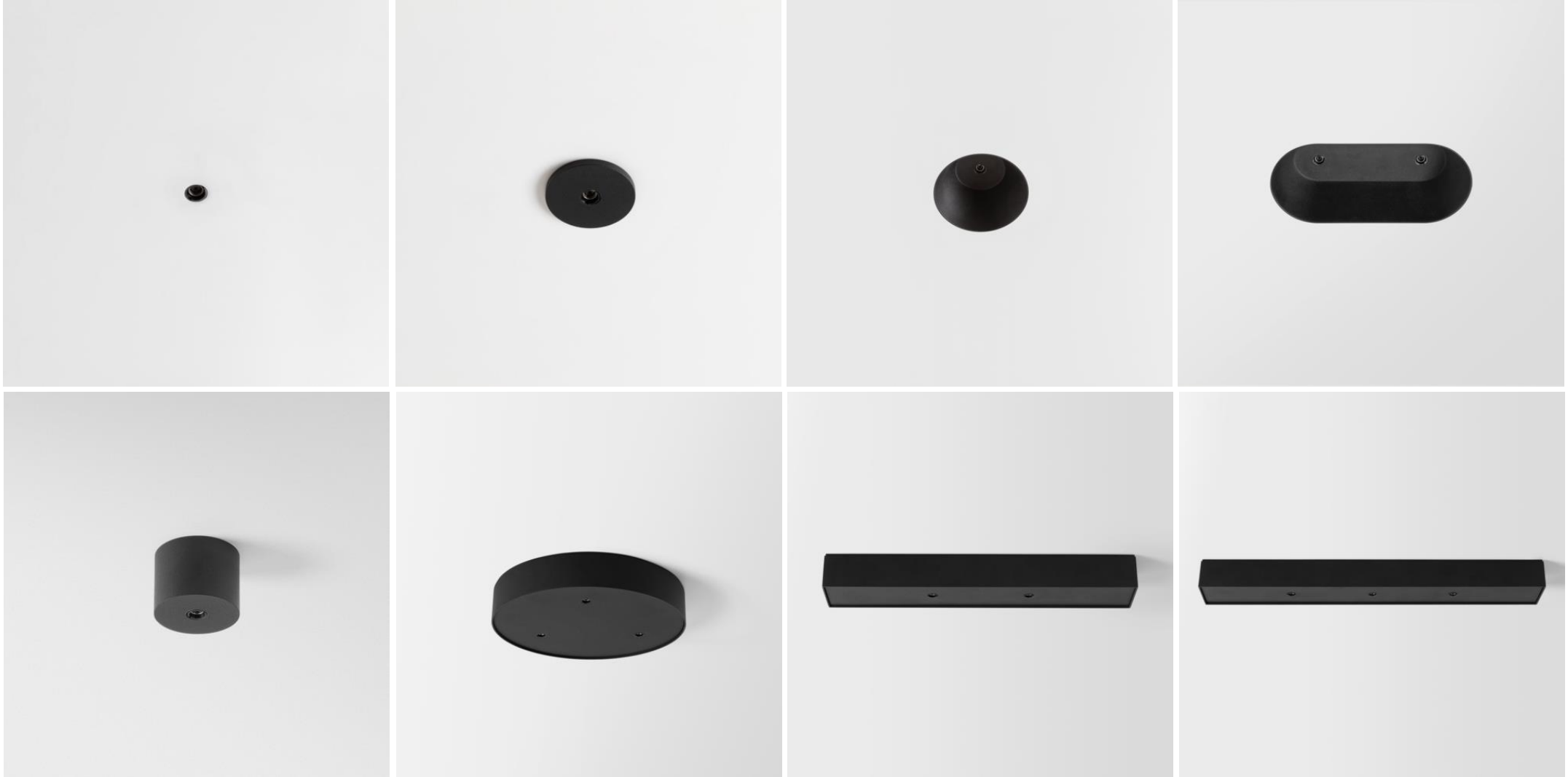

Modupoint | jack fixtures & sticks

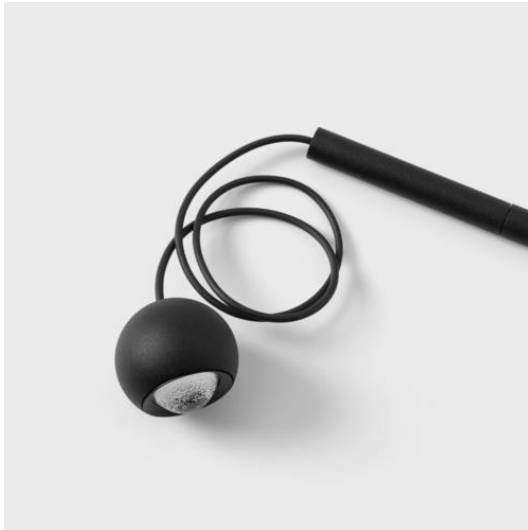

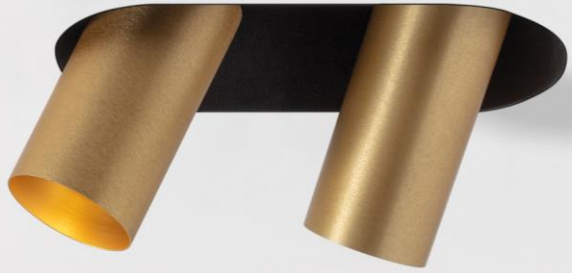

Modupoint | round panel mount

NEW

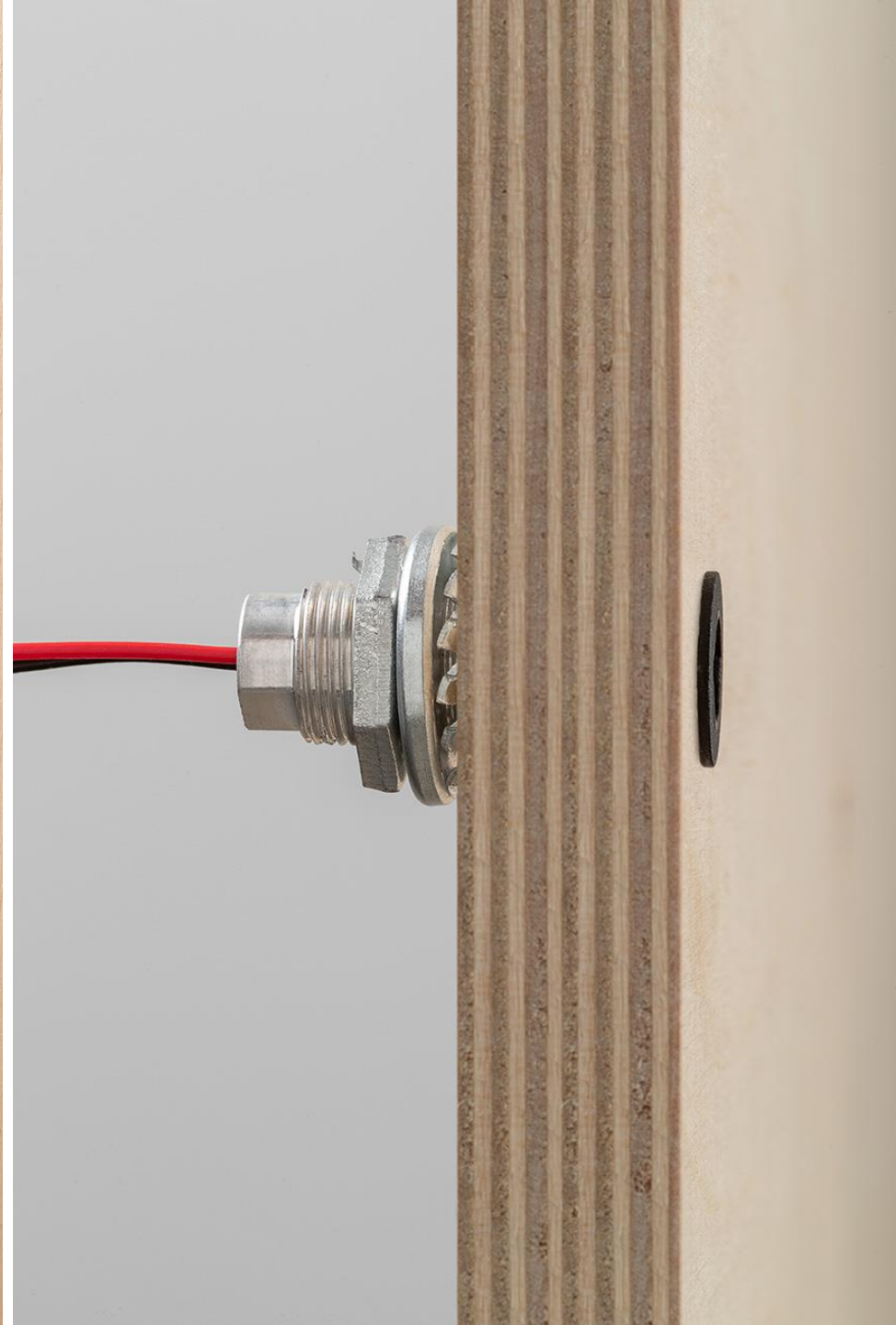

Modupoint | round panel mount

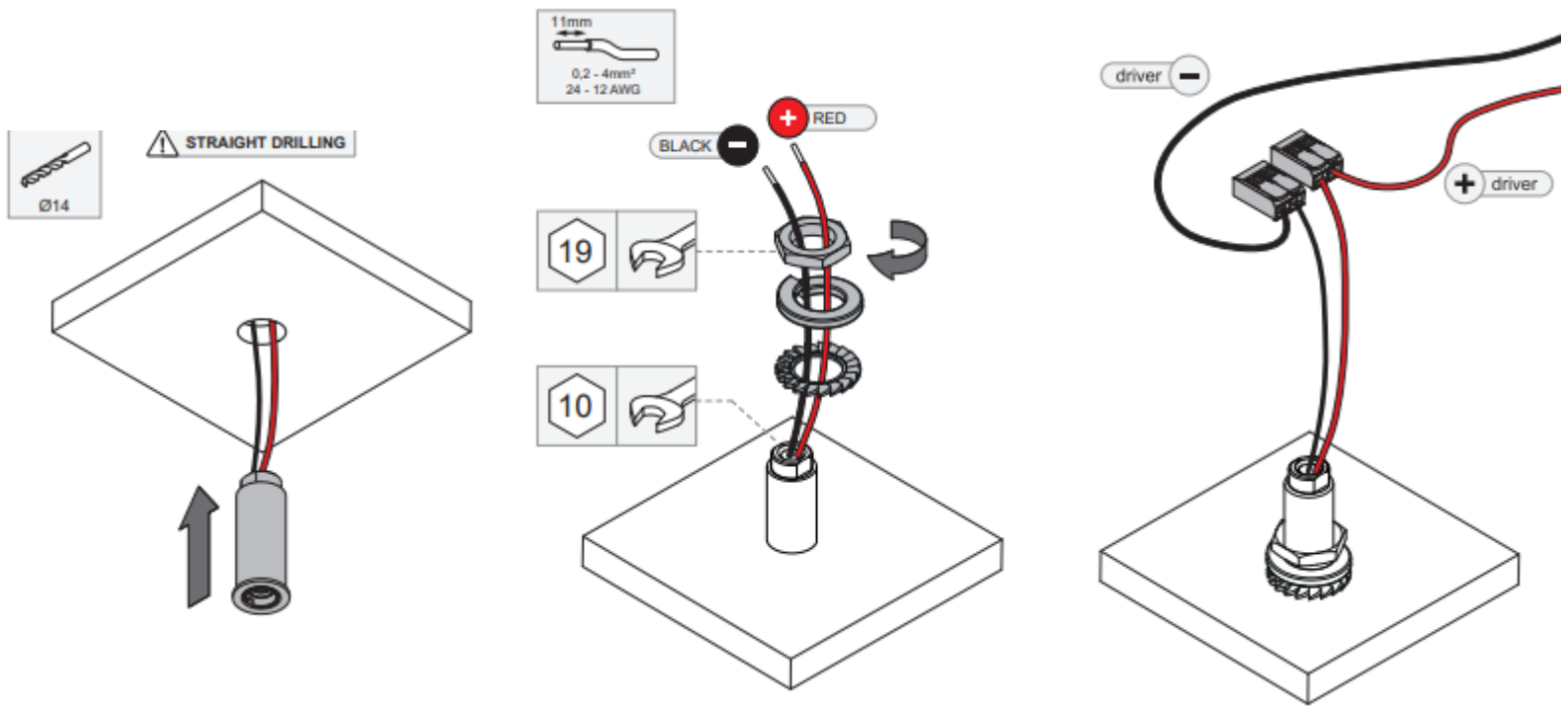

The back of panel must be accessible for fixation !

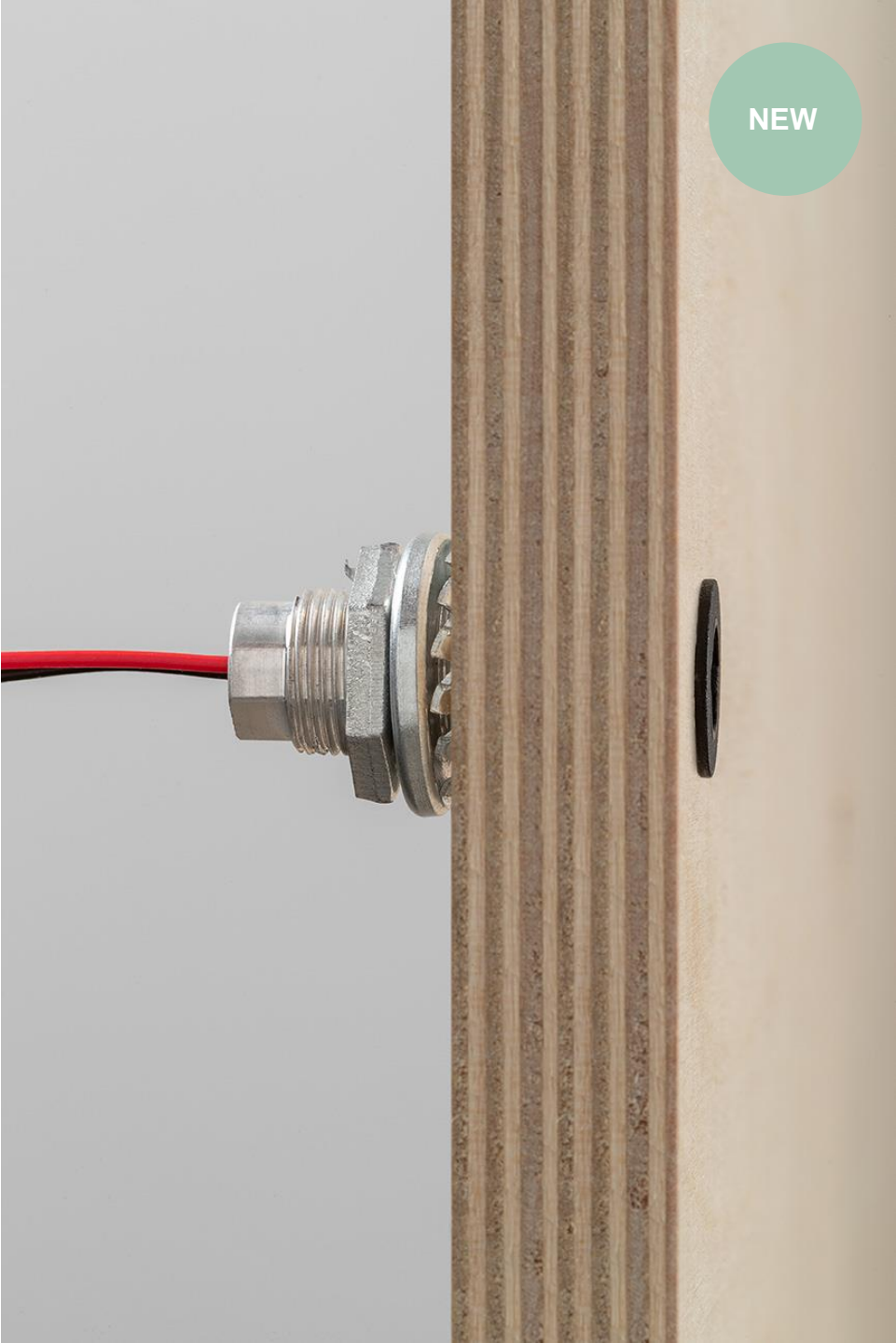

Modupoint| round panel mount

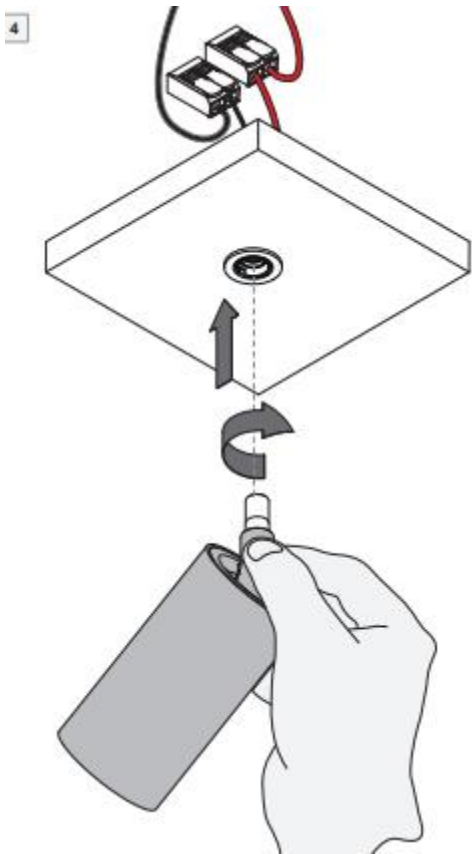

Modupoint| round panel mount



Ø 17mm





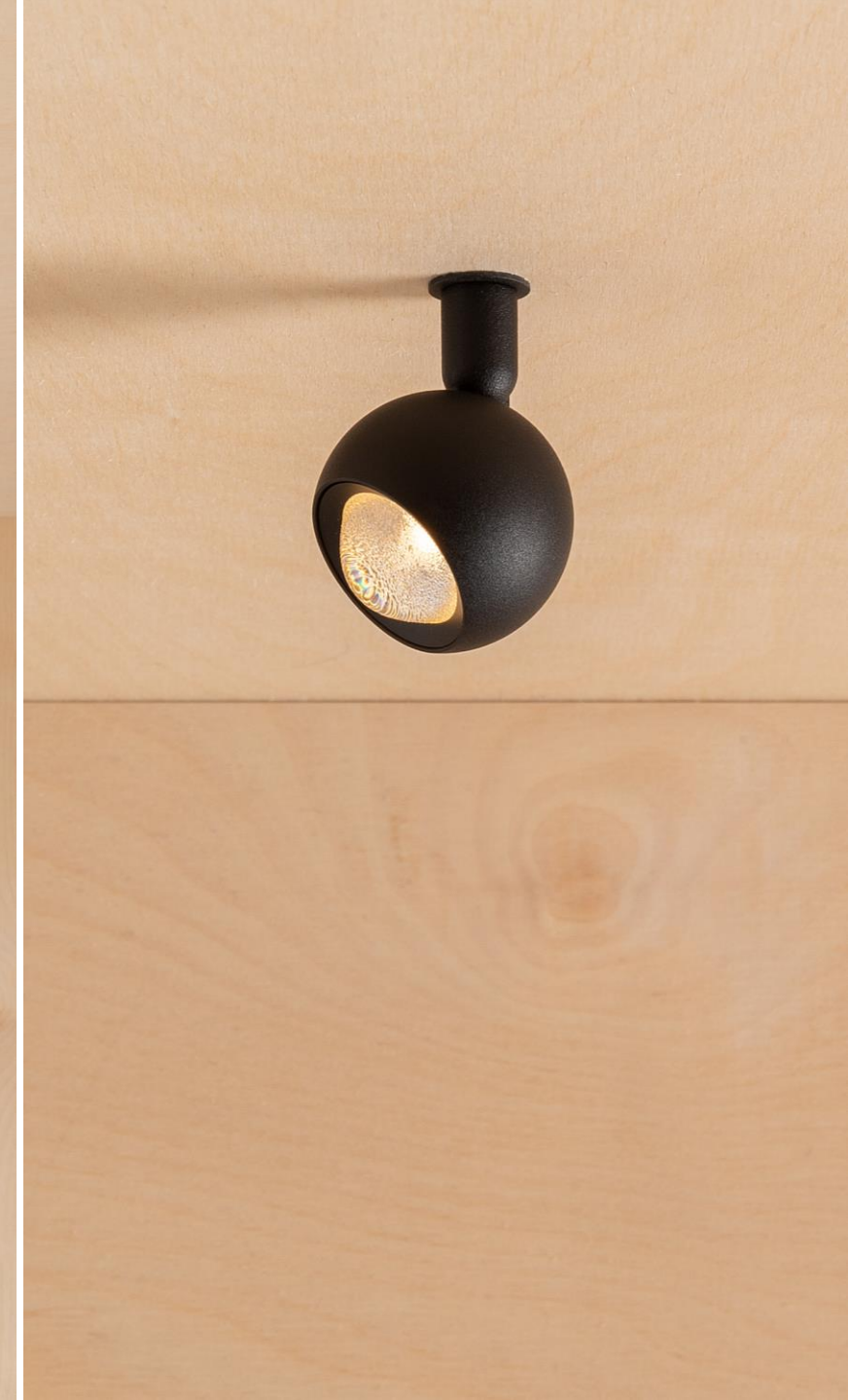

Modupoint| round panel mount

WALL INSTALLATION



DESK INSTALLATION

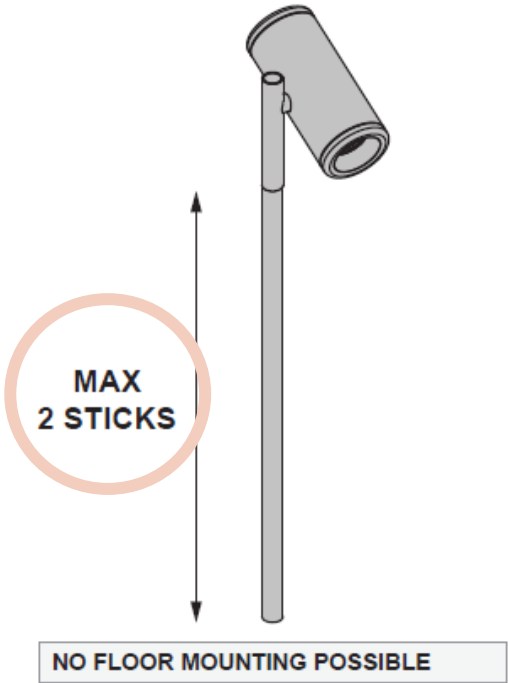

CEILING INSTALLATION

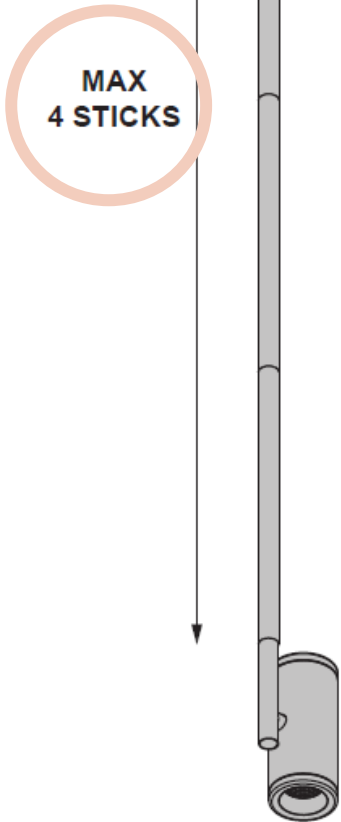



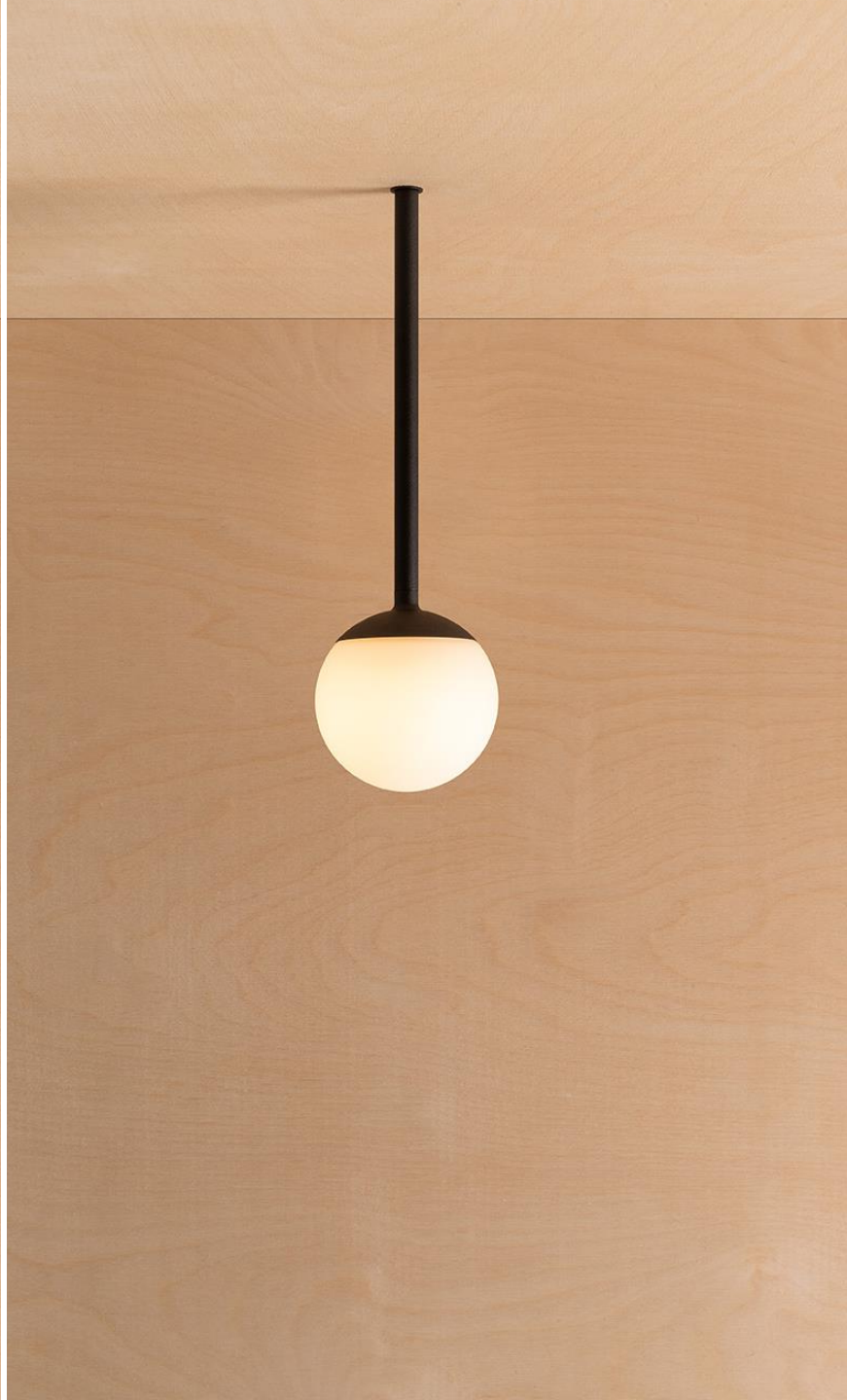









Tetrix



TETRIX STRAIGHT



TETRIX OBLIQUE



TETRIX ADJUSTABLE

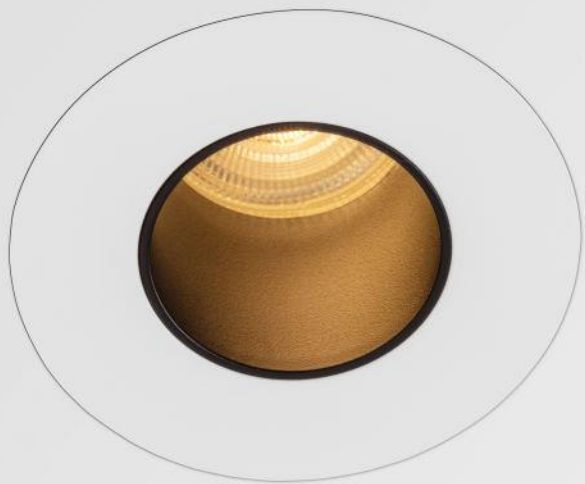

TETRIX PINHOLE



TETRIX CONE

Tetrix | Tube

NEW



NEW

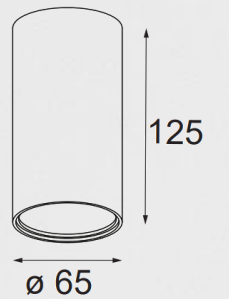

Tetrix | Tube

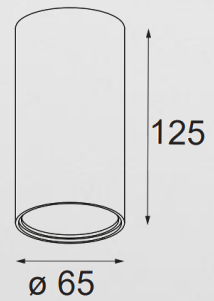

IP20

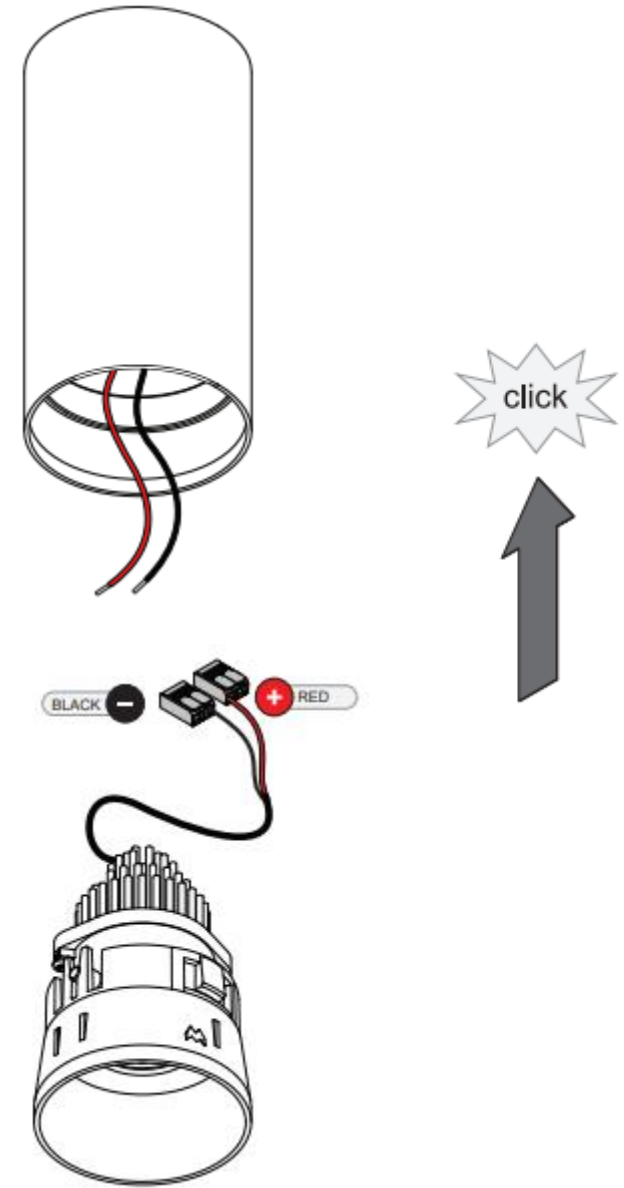

NOT COMPATIBLE WITH TETRIX GU10

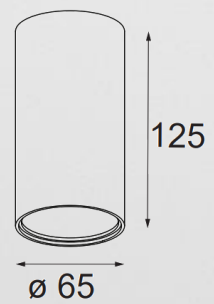

IP55

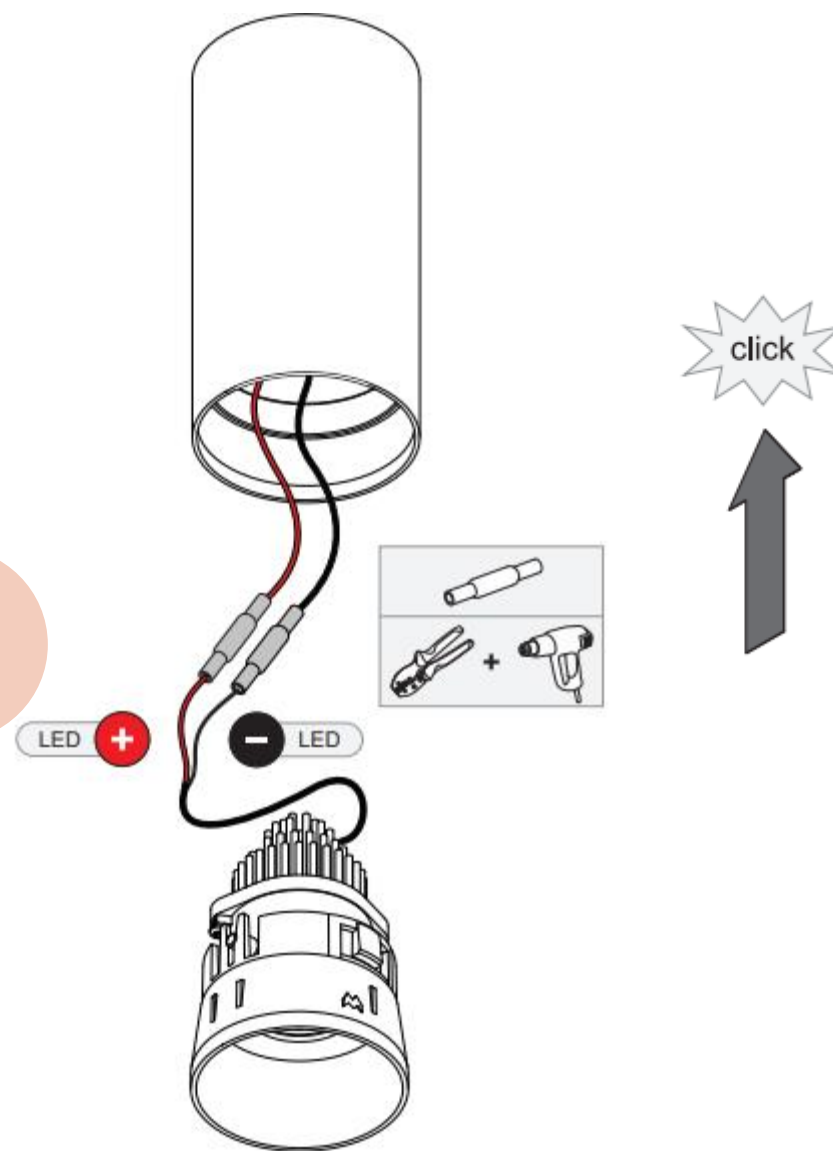

NOT COMPATIBLE WITH TETRIX GU10

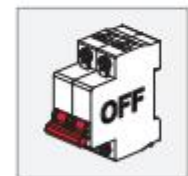

driver +

- driver

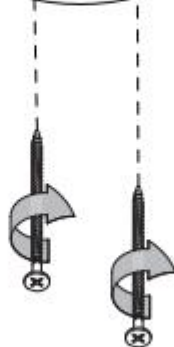
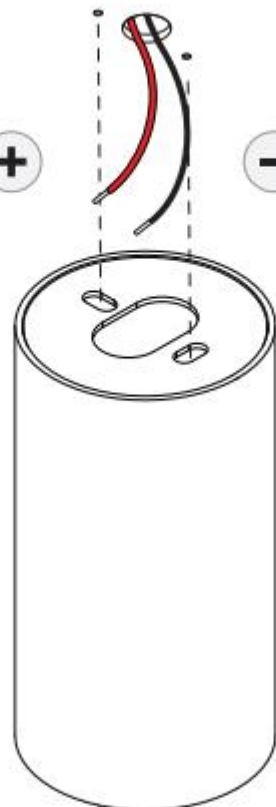

SCREWS NOT INCLUDED

max Ø4,5 mm

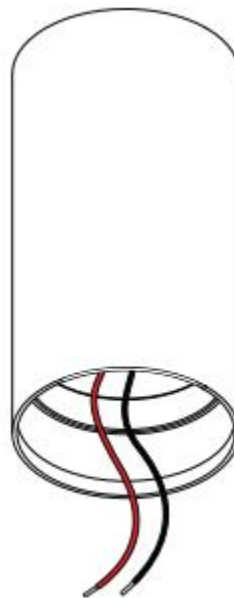

BLACK - + RED

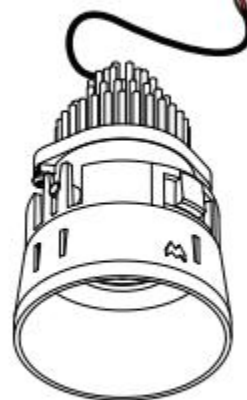

visualisation with 'Tetrix Straight 62 LED DE'
fixture not included



Not compatible with: Tetrix LED GU10 & GU10 Hue.

click

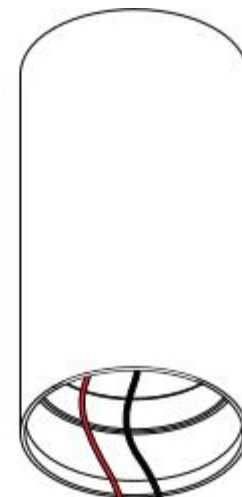

LED +

- LED

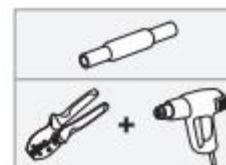
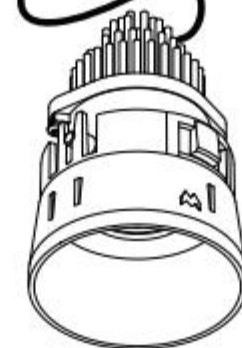

Tetrix | Tube





TETRIX TUBE | TETRIX STRAIGHT









TETRIX TUBE | TETRIX OBLIQUE











TETRIX TUBE | TETRIX CONE



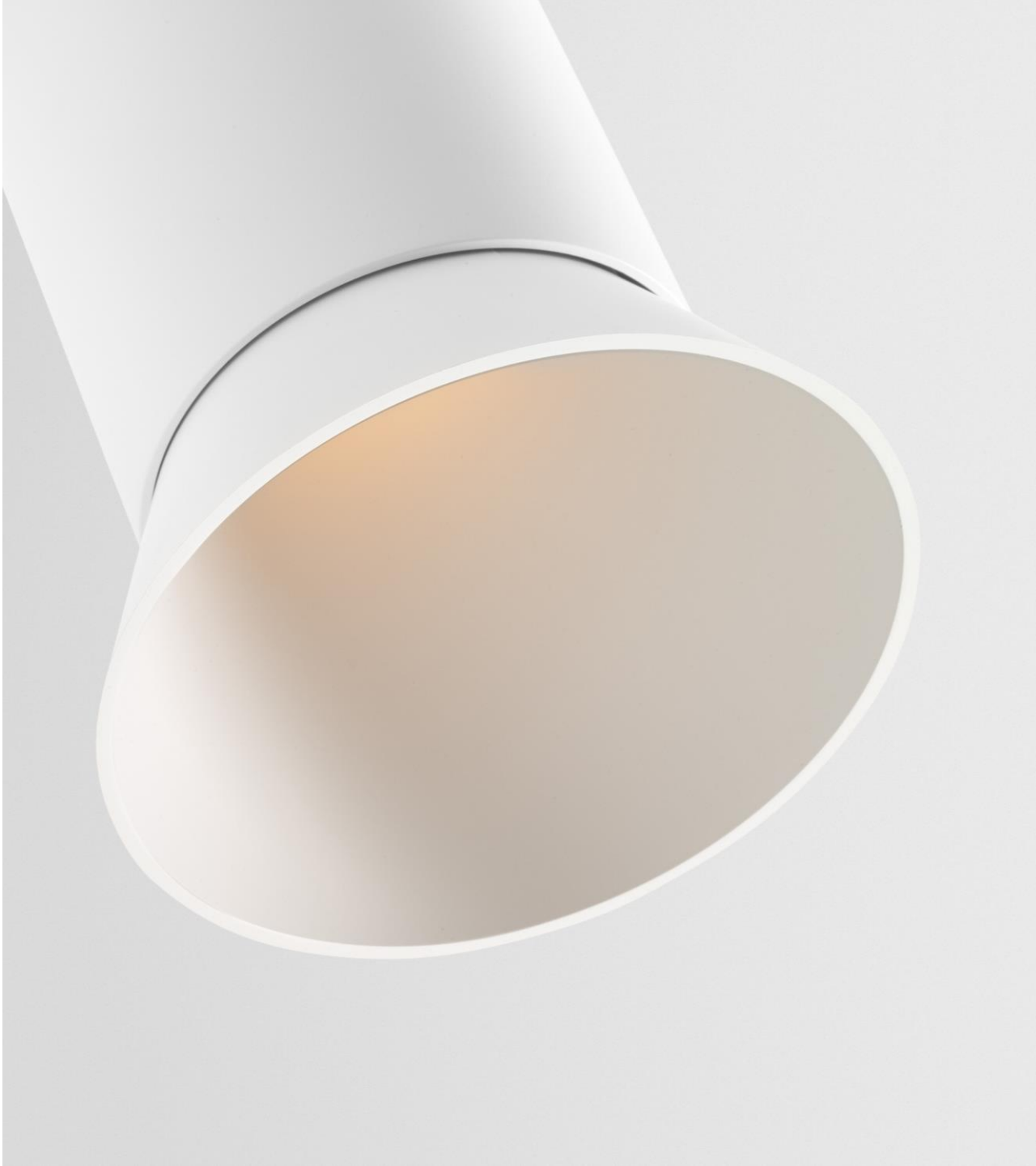







TETRIX TUBE | TETRIX ADJUSTABLE

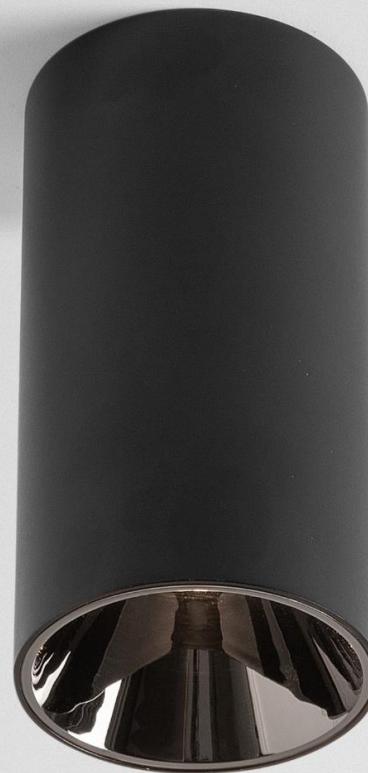

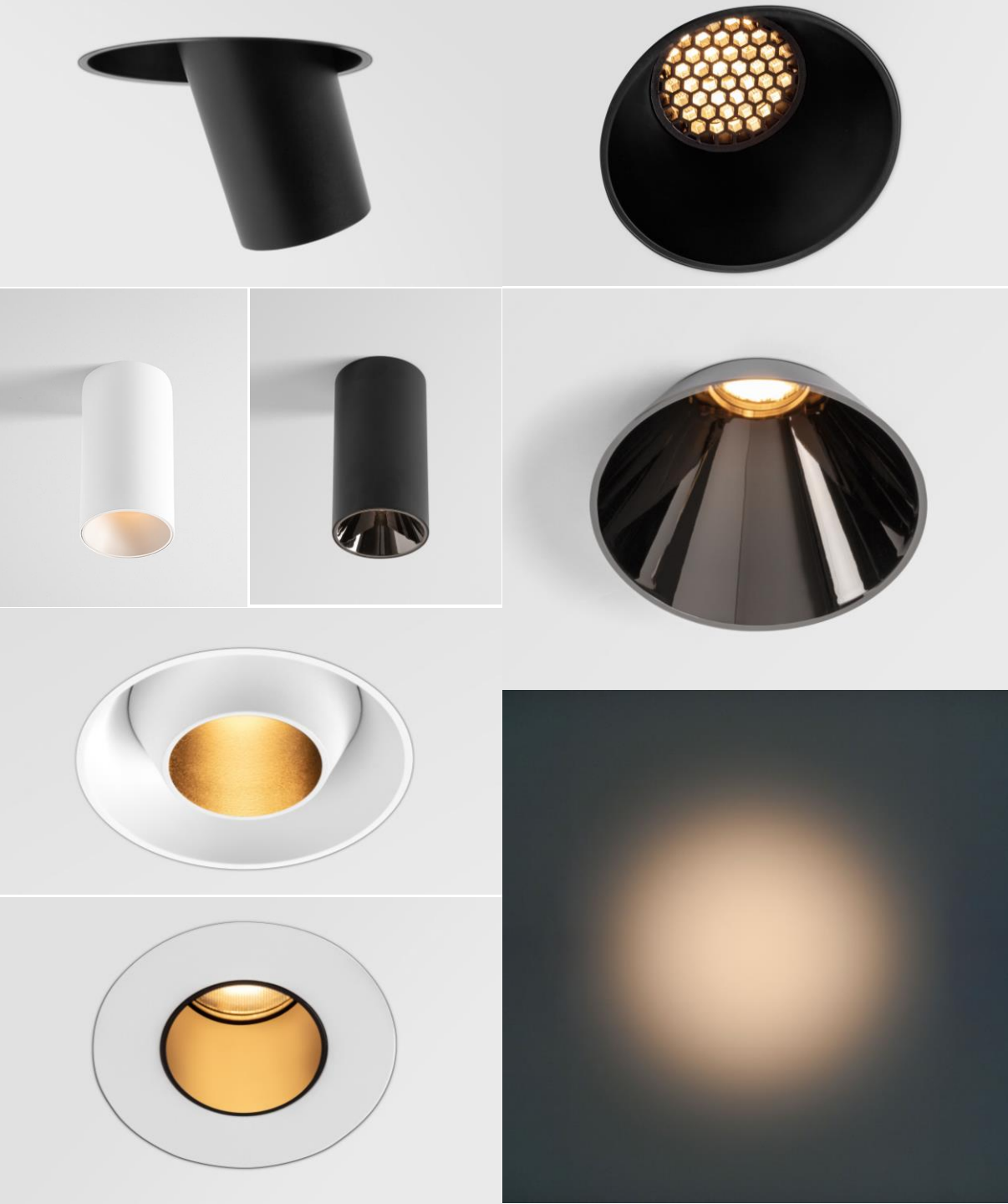

Tetrix

What's in a name

- Tetrix refers to the game: playing with pieces, fitting them together in all kinds of intricate ways.

Key features

- Accessible design at competitive price level
- GU10 version allows easy smart lighting solution
- Cascade of playful design possibilities
 - 5 designs; 2 installation frames; 1 tube; 4 lighting accessories
 - All aluminum (frames) and polycarbonate (designs/tubes/lighting accessories) components can be clicked into one another interchangeably.
- Deep recessed spot for enhanced visual comfort
- 4 lighting accessories with both anti-glare and aesthetical value
- Highly efficient polycarbonate TIR lens creates uniform light beam
- IP55 rating for all LED dedicated designs; including the adjustable and tube versions
- A breeze to install thanks to the extensive range of installation accessories
- Easy adjustment of the recessed ring to the desired plaster thickness

Designed by Modular Lighting Instruments

Track 230V

Track 230V Power Wire Bending Tool



1

CUT THE TRACK WITH EXACT PERPENDICULAR FINISH

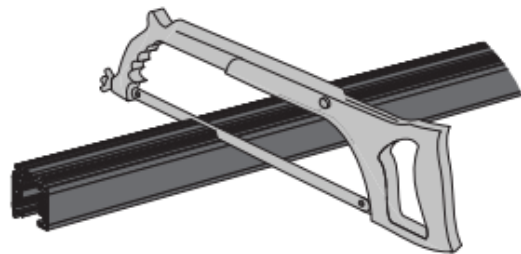

⚠ CUT PERPENDICULAR!

2

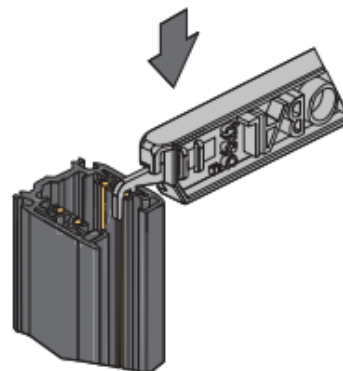
INSERT BENDING TOOL AS DEEP AS POSSIBLE
TO ENSURE BENDING POINT IS AT THE CORRECT PLACE

3

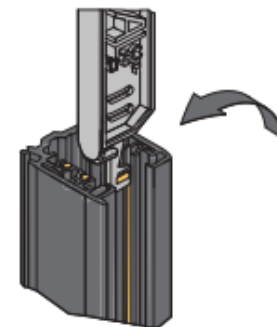
BEND THE 4 COPPER WIRES
(for dali tracks: middle dali coppers do not require bending)

4

INSERT OTHER END OF THE TOOL TO CHECK IF ALL BENDS ARE CORRECT

the tool must fit between the copper ends and the side of the tool must slide to even level with the end surface of the track.

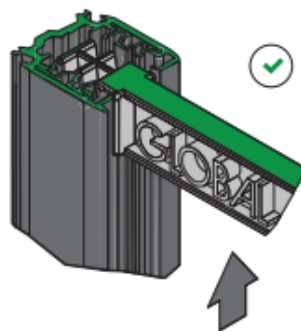

5

COMPLETED AND READY FOR FURTHER INSTALLATION



